



COFFS HARBOUR CITY COUNCIL
ORDINARY MEETING
COUNCIL CHAMBERS
COUNCIL ADMINISTRATION BUILDING
COFF AND CASTLE STREETS, COFFS HARBOUR
3 JULY 2008

Contents

ITEM	DESCRIPTION	PAGE
	CITY SERVICES DEPARTMENT REPORTS	1
S31	TRAFFIC COMMITTEE REPORT NO. 4/2008	1
S32	NATIONAL SURF LIFE SAVING CHAMPIONSHIPS, BOAMBEE BEACH - PART 3A APPLICATION	19
S33	WATER EFFICIENCY STRATEGIC PLAN - ADOPTION OF REVIEWED PLAN	21



COFFS HARBOUR CITY COUNCIL

ORDINARY MEETING

3 July 2008

Mayor and Councillors

CITY SERVICES DEPARTMENT REPORTS

S31 TRAFFIC COMMITTEE REPORT NO. 4/2008

Purpose:

To confirm minutes from the Traffic Committee Meeting held on 17 June 2008.

Recommendation:

T.30 – Dorset Street, Coffs Harbour - Double Lines (R.509810 [1880098])

That 20m of double unbroken centre lines be painted in Dorset Street, Coffs Harbour, from the intersections of Shephards Lane and Coriedale Drive, as per Plan T.30.

T.31 – Butlers Road, Bonville - Speed Limit (R.500540 [1903871])

That traffic counts be undertaken on Butlers Road, Bonville, and the results brought back to Traffic Committee.

T.32 – Bent Street, Coffs Harbour - One Way Laneway (R.502870 [1818186])

That no action be taken to implement the laneway as 'One Way' between Bent Street and Harbour Drive, Coffs Harbour.

T.33 – Harbour Drive, Coffs Harbour - 'No Parking' (Harbour Drive [1914120])

That a new disabled bay be installed in Harbour Drive, Coffs Harbour, adjacent to the Museum, and the existing disabled bay be converted to ramp access, as per Plan T.33.

T.34 – Prince James Avenue, Coffs Harbour - Traffic Calming (R.505790 [1807381])

That no action be taken to install speed humps in Prince James Avenue, Coffs Harbour, between Coral Avenue and Plantation Avenue.

T.35 – Hi-Tech Drive, Toormina - 'Bus Zone' signs (R.501670)

That the request for a Bus Zone in Hi-Tech Drive, Toormina, adjacent the Coffs Harbour Bible Church School, be deferred pending investigation for a 40km/h school zone.

T.36 – Red Rock Road / Coral Street, Corindi - 'Give Way' sign (Red Rock Road [1861757])

That no action be taken to install a 'Give Way' sign in Red Rock Road, Corindi, at the intersection with Coral Street.

T.37 – Christmas Bells Road, Coffs Harbour - Speed Limit (R.510580)

That speed advisory signs be installed at the bend on Christmas Bells Road, Coffs Harbour, as per Plan T.37.

T.38 – Edinburgh Street, Coffs Harbour - '30 Minute' parking (R.504100)

That two '30 minute' parking bays be installed in Edinburgh Street, Coffs Harbour, adjacent to the Jetty Theatre, as per Plan T.38.

T.39 – Boundary Street, Woolgoolga - '1 Hour' parking (R.508420)

That '1 hour' parking be installed in four spaces in Boundary Street, Woolgoolga, adjacent the Visitor Information Centre, as per Plan T.39.

T.40 – Market Street, Woolgoolga - 'Loading Zone' (R.508710)

That the request for a 'Loading Zone' in Market Street, Woolgoolga, be approved, as per Plan T.40.

T.41 – Beach Street, Woolgoolga - 'Motorcycle' parking (R.508400)

That motorcycle parking be installed in Beach Street, Woolgoolga, to one existing parallel space, opposite the intersection with Wharf Street, as per Plan T.41.

T.42 – Crossmalgen Road, Crossmaglen - Speed Limit (R.500310 [1857106])

That the request for a reduction in speed limit on Crossmaglen Road, Crossmaglen, between Gleniffer Road and No. 130, be referred to the Roads and Traffic Authority for review.

T.43 – First Avenue, Sawtell - Pedestrian Plans (R.501520)

That the 40km/h high pedestrian activity plans for First Avenue, Sawtell, be approved as per Plan T.43.

T.44 – Beryl Street / Bray Street, Coffs Harbour - Speeding Cars (R.503870 / R.503240)

That approaches be made to the local Police for patrols of Beryl Street and Bray Street, Coffs Harbour, as 85th percentile speeds are high at certain times.

T.45 – Earl Street, Coffs Harbour - On-street Parking (R.503120)

That the plans for on-street parking in Earl Street, Coffs Harbour, be approved, as per Plan T.45.

T.46 – Mildura Street, Coffs Harbour - On-Street Parking (R.505300)

That the plans for on-street parking in Mildura Street, Coffs Harbour, be approved as per Plan T.46.

Attachments:

**COFFS HARBOUR CITY COUNCIL
TRAFFIC COMMITTEE MINUTES– 4/2008
17 JUNE 2008 - 10.30AM**

Present: Sgt Wayne Thorpe, Coffs Harbour Police
Liz Smith, Roads and Traffic Authority
Darren Williams, Sawtell Coaches
George Stulle, Coffs Harbour City Council
Rob Fletcher, Coffs Harbour City Council
David Brooks, Coffs Harbour City Council

Apologies: Andrew Fraser MP
Cr Bill Palmer, Coffs Harbour City Council
Greg Miers, Busways

Minute Taker: Ann Graham, Coffs Harbour City Council

T.30 – Dorset Street, Coffs Harbour - Double Lines (R.509810 [1880098])

Consideration to a request from a resident for double unbroken centre lines to be painted in Dorset Street, Coffs Harbour, to stop vehicles cutting the corner at Shephards Lane and Coriedale Drive.

Recommended: that 20m of double unbroken centre lines be painted in Dorset Street, Coffs Harbour, from the intersections of Shephards Lane and Coriedale Drive, as per Plan T.30.

Reason: To increase safety of vehicles turning from and into the intersections.

T.31 – Butlers Road, Bonville - Speed Limit (R.500540 [1903871])

Consideration to a request from a resident for a reduction in speed limit on Butlers Road, Bonville, as trucks driving on the road make it unsafe for residents.

Recommended: that traffic counts be undertaken on Butlers Road, Bonville, and the results brought back to Traffic Committee.

T.32 – Bent Street, Coffs Harbour - One Way Laneway (R.502870 [1818186])

Consideration to a request for the laneway between Bent Street and Harbour Drive, Coffs Harbour, be signposted as 'One Way'.

Recommended: that no action be taken to implement the laneway as 'One Way' between Bent Street and Harbour Drive, Coffs Harbour.

Reason: Traffic volumes are minimal and therefore does not warrant one-way implementation.

T.33 – Harbour Drive, Coffs Harbour - 'No Parking' (Harbour Drive [1914120])

Consideration to a request from Support Services for 'No Parking' in front of ramp and a 'Disabled Parking' space adjacent to the Museum in Harbour Drive, Coffs Harbour.

Recommended: that a new disabled bay be installed in Harbour Drive, Coffs Harbour, adjacent to the Museum, and the existing disabled bay be converted to ramp access, as per Plan T.33.

Reason: The ramp is blocked if a vehicle is parked in the existing disabled bay, the changes will provide clear access.

T.34 – Prince James Avenue, Coffs Harbour - Traffic Calming (R.505790 [1807381])

Consideration to a request from a resident for the installation of speed humps in Prince James Avenue, Coffs Harbour, between Coral Avenue and Plantation Avenue.

Recommended: that no action be taken to install speed humps in Prince James Avenue, Coffs Harbour, between Coral Avenue and Plantation Avenue.

Reason: Traffic counts have shown that 85th percentile speeds are satisfactory.

T.35 – Hi-Tech Drive, Toormina - 'Bus Zone' signs (R.501670)

Consideration to a request from the Coffs Harbour Bible Church School for a Bus Zone outside the school in Hi-Tech Drive, Toormina.

Recommended: that the request for a Bus Zone in Hi-Tech Drive, Toormina, adjacent the Coffs Harbour Bible Church School, be deferred pending investigation for a 40km/h school zone.

T.36 – Red Rock Road / Coral Street, Corindi - 'Give Way' sign (Red Rock Road [1861757])

Consideration to a request from the Corindi Beach Residents Group for a 'Give Way' sign to be erected at the intersection of Red Rock Road and Coral Street, Corindi.

Recommended: that no action be taken to install a 'Give Way' sign in Red Rock Road, Corindi, at the intersection with Coral Street.

Reason: The intersection is a standard T-intersection with hazard sightboard and linemarking and does not warrant a 'Give Way' sign.

T.37 – Christmas Bells Road, Coffs Harbour - Speed Limit (R.510580)

Consideration to a request for the speed limit on Christmas Bells Road, Coffs Harbour, to be reduced to 50 or 60km/h.

Recommended: that speed advisory signs be installed at the bend on Christmas Bells Road, Coffs Harbour, as per Plan T.37.

Reason: Christmas Bells Road is an undeveloped rural standard road which does not warrant a speed restriction. The installation of a speed advisory sign at the bend in Christmas Bells Road will improve safety on the bend.

T.38 – Edinburgh Street, Coffs Harbour - '15 Minute' parking (R.504100)

Consideration to a request for '15 minute' parking to be installed in Edinburgh Street, Coffs Harbour, adjacent to the Jetty Theatre.

Recommended: that two '30 minute' parking bays be installed in Edinburgh Street, Coffs Harbour, adjacent to the Jetty Theatre, as per Plan T.38.

Reason: To prevent all-day parking and enable better use of access to the Jetty Theatre during the day.

T.39 – Boundary Street, Woolgoolga - '15 Minute' parking (R.508420)

Consideration to a request from Chamber of Commerce for '15 minute' parking to be installed in Boundary Street, Woolgoolga, adjacent to the Visitor Information Centre.

Recommended: that '1 hour' parking be installed in four spaces in Boundary Street, Woolgoolga, adjacent the Visitor Information Centre, as per Plan T.39.

Reason: To enable access by visitors and prevent all day parking. The 1 hour restriction will achieve this better than a 15 minute and be consistent with adjacent parking controls in Beach Street.

T.40 – Market Street, Woolgoolga - 'Loading Zone' (R.508710)

Consideration to a request from Chamber of Commerce for conversion of 'No Parking' zone on northern side of Market Street near intersection with Nightingale Street to a 'Loading Zone' as it is constantly used for business deliveries.

Recommended: that the request for a 'Loading Zone' in Market Street, Woolgoolga, be approved, as per Plan T.40.

Reason: The installation of a Loading Zone will allow for efficient deliveries in Market Street, Woolgoolga.

T.41 – Beach Street, Woolgoolga - 'Motorcycle' parking (R.508400)

Consideration to a request from Chamber of Commerce for conversion of two parallel parking spaces in Beach Street, Woolgoolga, to motorcycle parking (opposite intersection with Wharf Street).

Recommended: that motorcycle parking be installed in Beach Street, Woolgoolga, to one existing parallel space, opposite the intersection with Wharf Street, as per Plan T.41.

Reason: There is ample 60° parking for cars in Beach Street but no motorcycle parking. With the loss of one car space, five motorcycle spaces will be created.

T.42 – Crossmaglen Road, Crossmaglen - Speed Limit (R.500310 [1857106])

Consideration to a request from a resident for the speed limit to be reduced on Crossmaglen Road, Crossmaglen, to enable safety when existing or entering properties.

Recommended: that the request for a reduction in speed limit on Crossmaglen Road, Crossmaglen, between Gleniffer Road and No. 130, be referred to the Roads and Traffic Authority for review.

Reason: The 85th percentile speed warrants review.

T.43 – First Avenue, Sawtell - Pedestrian Plans (R.501520)

Consider plans for 40km/h high pedestrian activity plans for First Avenue, Sawtell.

Recommended: that the 40km/h high pedestrian activity plans for First Avenue, Sawtell, be approved as per Plan T.43.

Reason: To ensure pedestrian safety following upgrade of Sawtell main street.

T.44 – Beryl Street / Bray Street, Coffs Harbour - Speeding Cars (R.503870 / R.503240)

Consideration to reports that cars are speeding in Beryl Street and Bray Street, Coffs Harbour.

Recommended: that approaches be made to the local Police for patrols of Beryl Street and Bray Street, Coffs Harbour, as 85th percentile speeds are high at certain times.

T.45 – Earl Street, Coffs Harbour - On-street Parking (R.503120)

Consider plans for on-street parking in Earl Street, Coffs Harbour.

Recommended: that the plans for on-street parking in Earl Street, Coffs Harbour, be approved, as per Plan T.45.

Reason: To provide additional parking as part of the CBD Parking DCP.

T.46 – Mildura Street, Coffs Harbour - On-Street Parking (R.505300)

Consider plans for on-street parking in Mildura Street, Coffs Harbour.

Recommended: that the plans for on-street parking in Mildura Street, Coffs Harbour, be approved as per Plan T.46.

Reason: To provide additional parking as part of the Jetty Parking DCP.

The meeting closed at 11.45am.

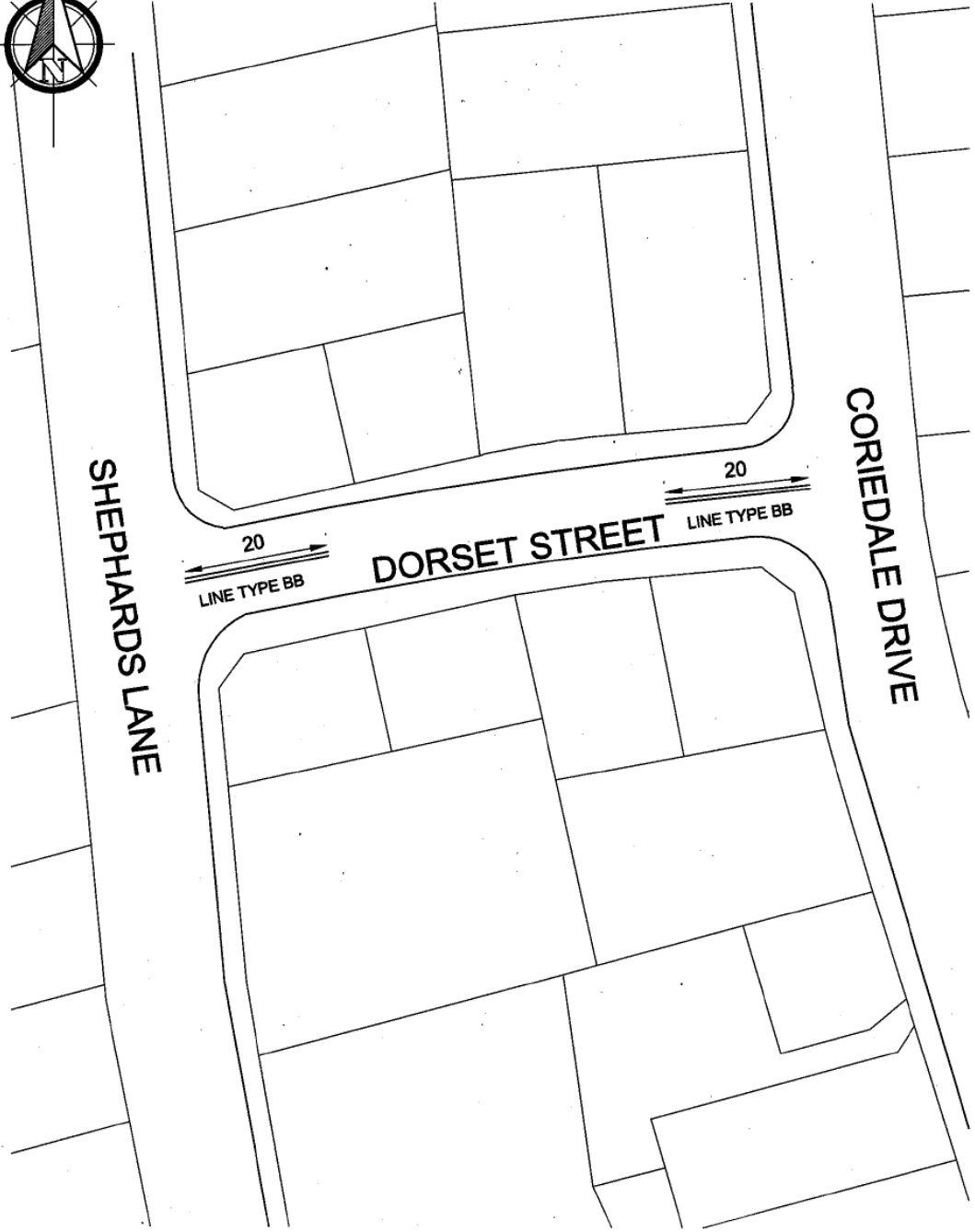

PLAN VIEW

NOTES:
20m OF DOUBLE UNBROKEN CENTER LINES TO BE PAINTED IN DORSET STREET, COFFS HARBOUR, FROM THE INTERSECTION OF SHEPARDS LANE AND CORIEDALE DRIVE.

DOUBLE LINES
T.30-2008
DORSET STREET
COFFS HARBOUR

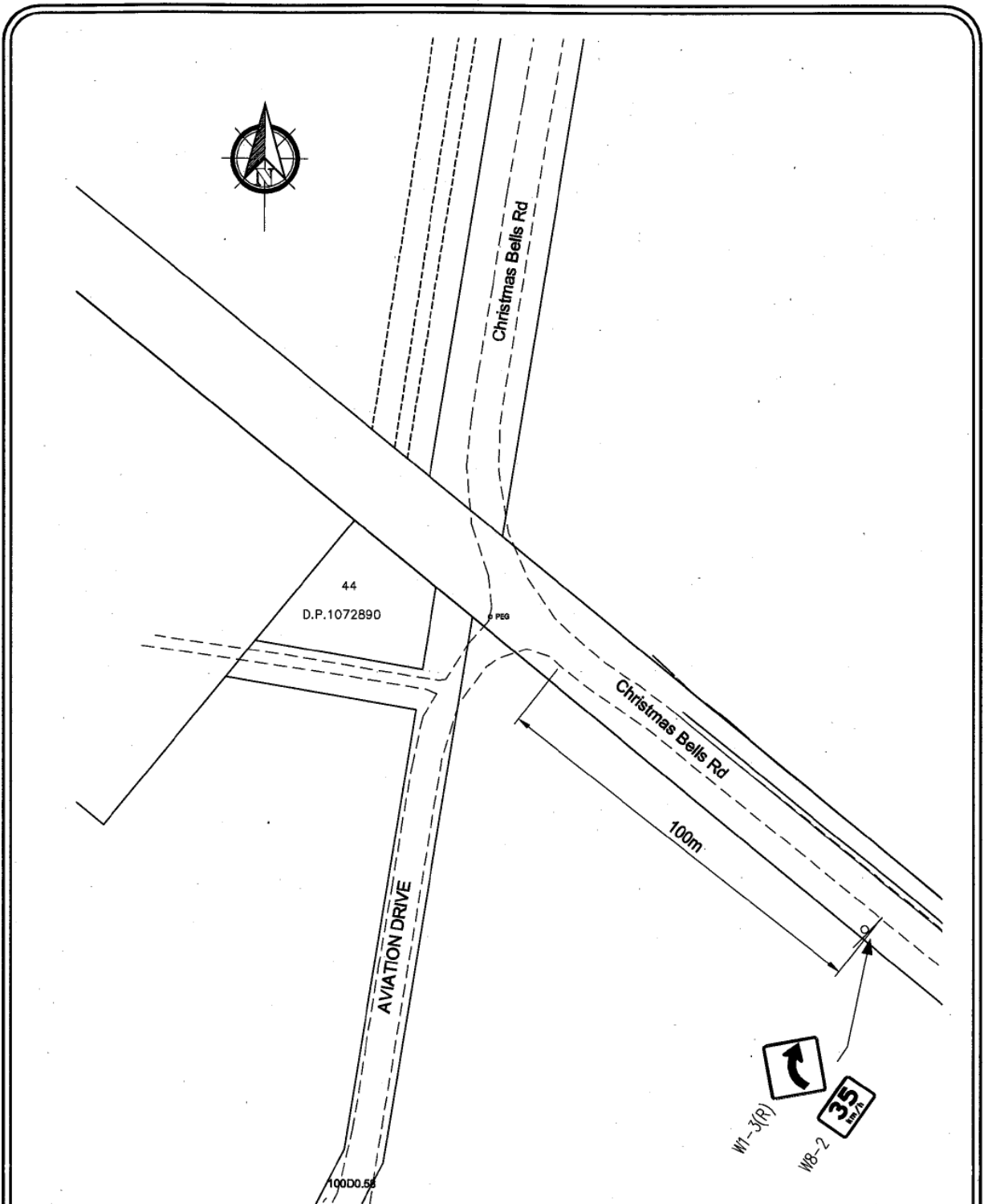

PLAN VIEW

NOTES:
THAT SPEED ADVISORY SIGNS BE INSTALLED AT
THE BEND ON CHRISTMAS BELLS ROAD, COFFS
HARBOUR,

SPEED ADVISORY

T.37-2008

CHRISTMAS BELLS ROAD
COFFS HARBOUR

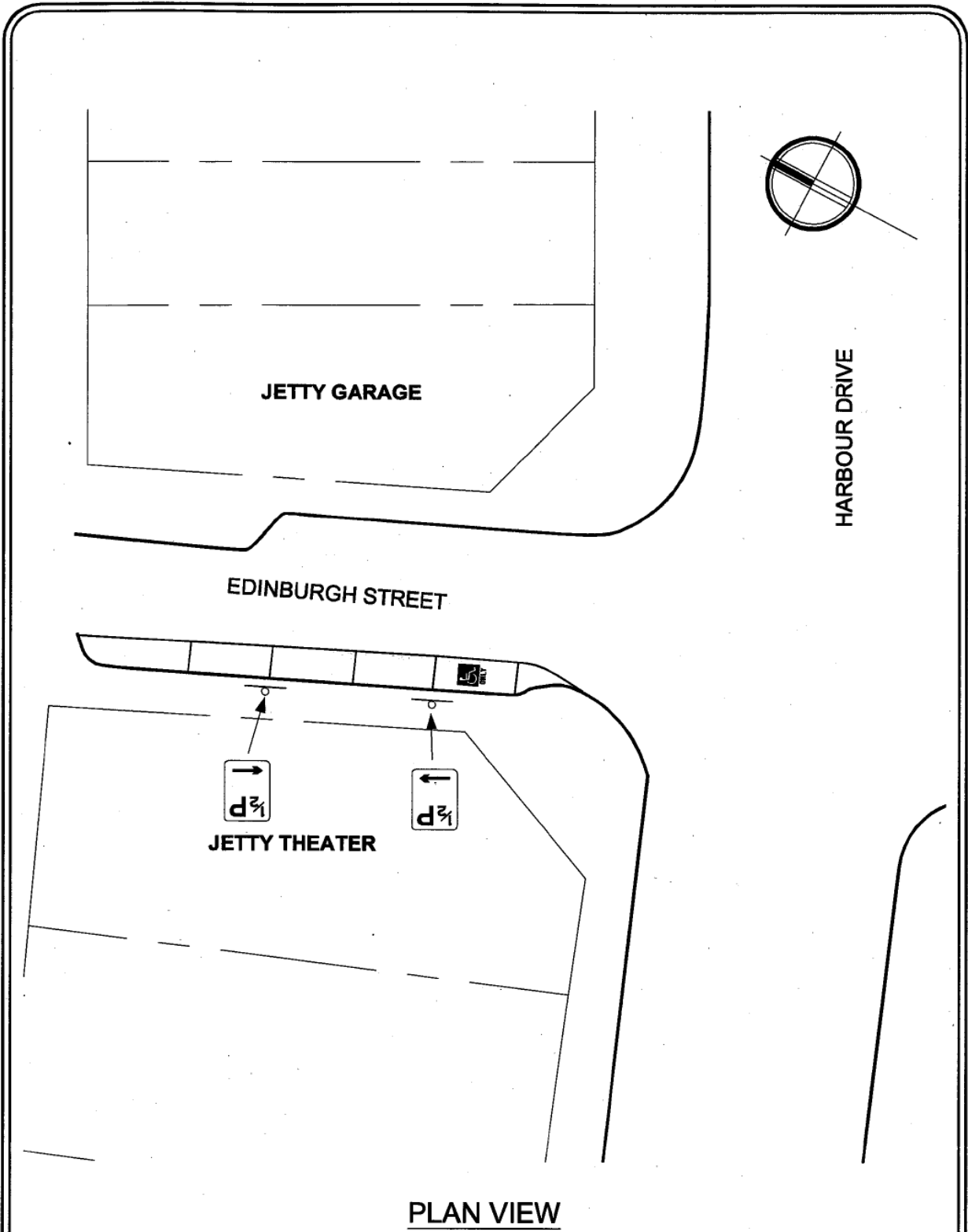

PLAN VIEW

NOTES:

THAT TWO '30 MINUTE' PARKING BAYS BE INSTALLED IN EDINBURGH STREET, COFFS HARBOUR, ADJACENT TO THE JETTY THEATRE.

TRAFFIC INSTRUMENT

T.38-2008
 EDINBURGH STREET
 COFFS HARBOUR

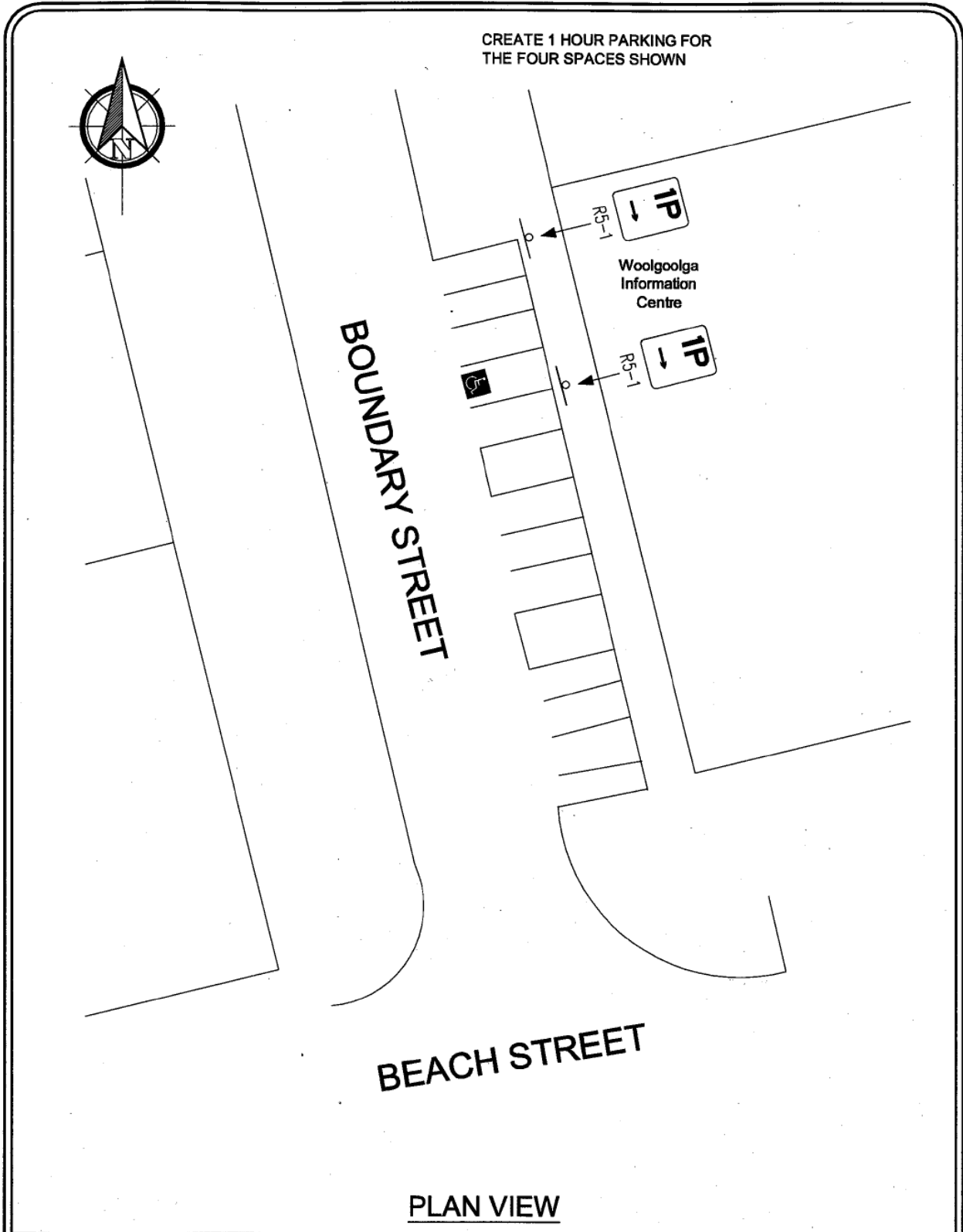

NOTES:
 1 HOUR PARKING TO BE INSTALLED IN FOUR SPACES WITHIN BOUNDARY STREET, WOOLGOOLGA, ADJACENT TO THE VISITOR INFORMATION CENTRE.

1 HOUR PARKING
 T.39-2008
 BOUNDARY STREET
 WOOLGOOLGA

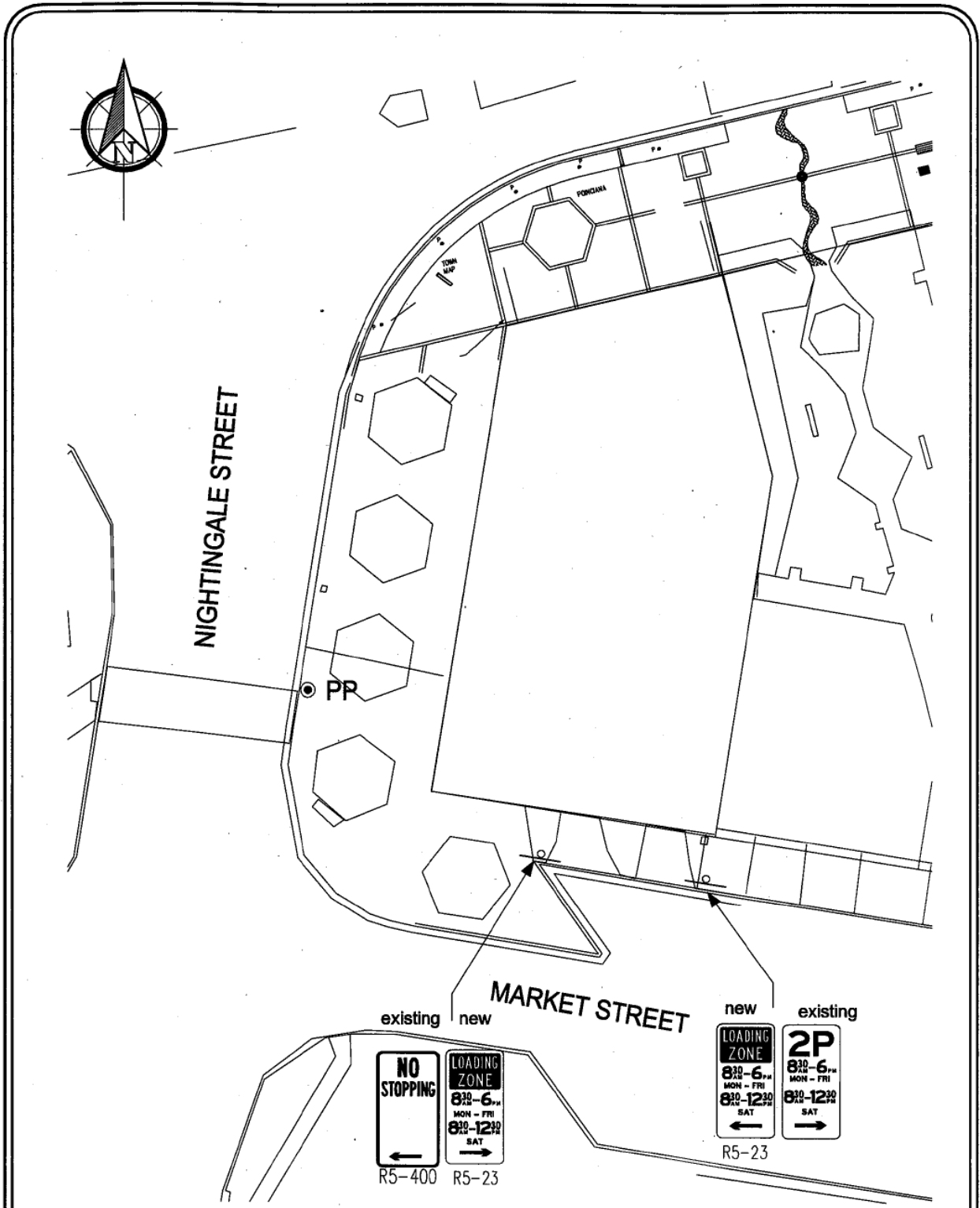

PLAN VIEW

NOTES:
 'Loading Zone' in Market Street to enable deliveries

LOADING ZONE
 T.40-2008
 MARKET STREET
 WOOLGOOLGA

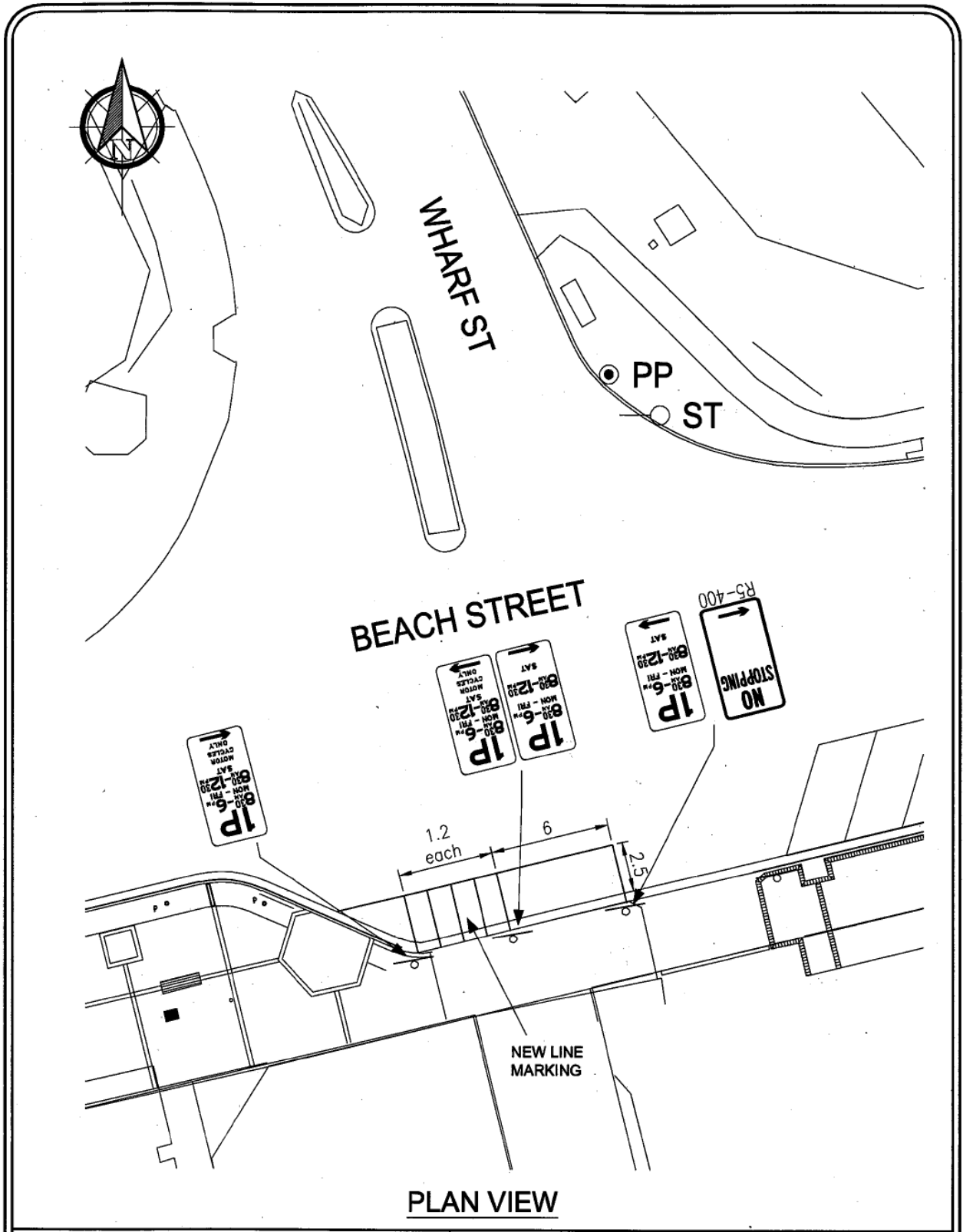

PLAN VIEW

NOTES:
 MOTORCYCLE PARKING TO BE INSTALLED IN BEACH STREET, WOOLGOOLGA, TO ONE EXISTING PARALLEL SPACE, OPPOSITE THE INTERSECTION WITH WHARF STREET.

MOTORCYCLE PARKING

T.41-2008
 BEACH STREET
 WOOLGOOLGA

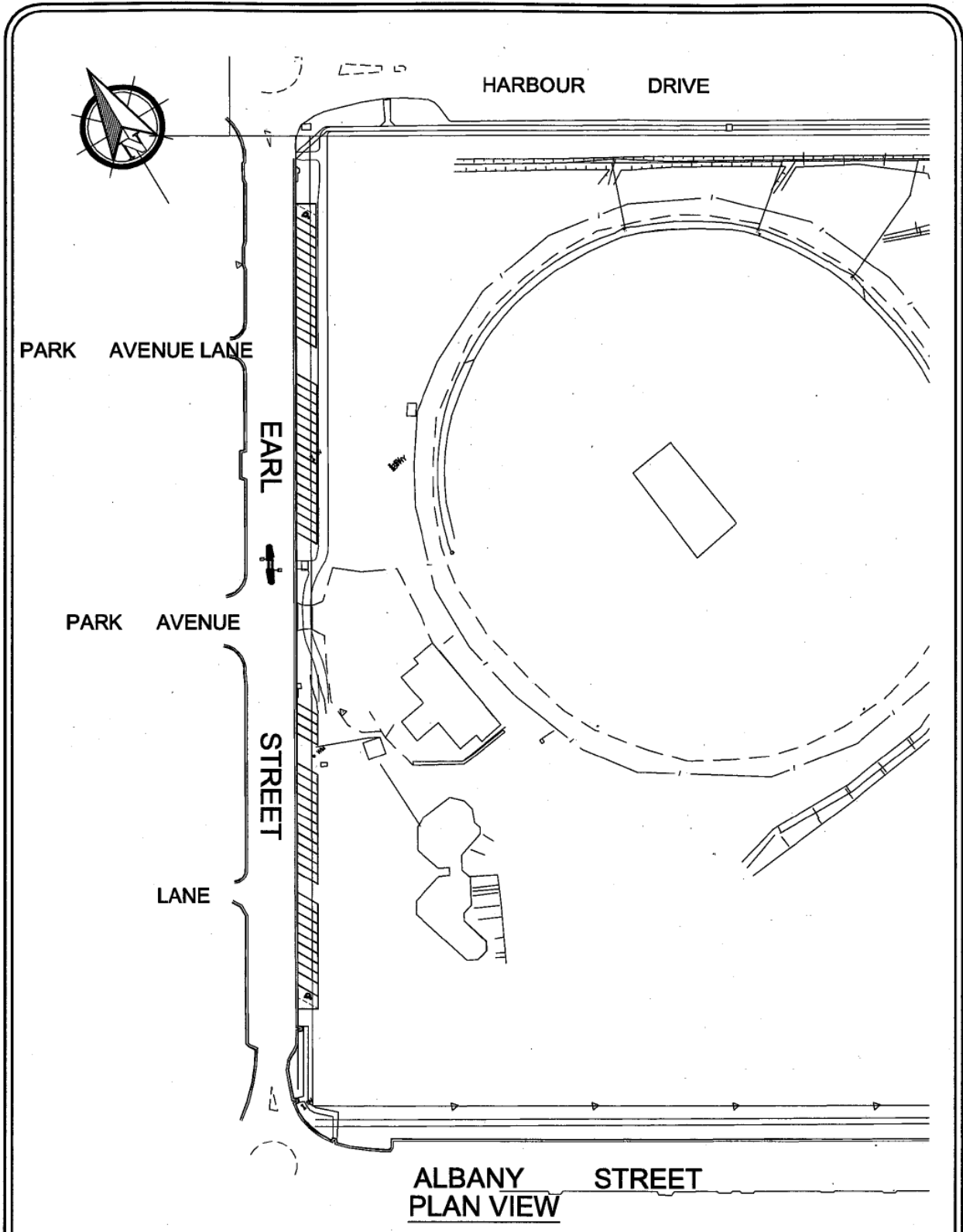

**ALBANY STREET
PLAN VIEW**

NOTES:
 PLANS FOR ON STREET PARKING IN EARL STREET, COFFS HARBOUR, BE APPROVED

60° ON STREET PARKING

T.45-2008
 EARL STREET
 COFFS HARBOUR

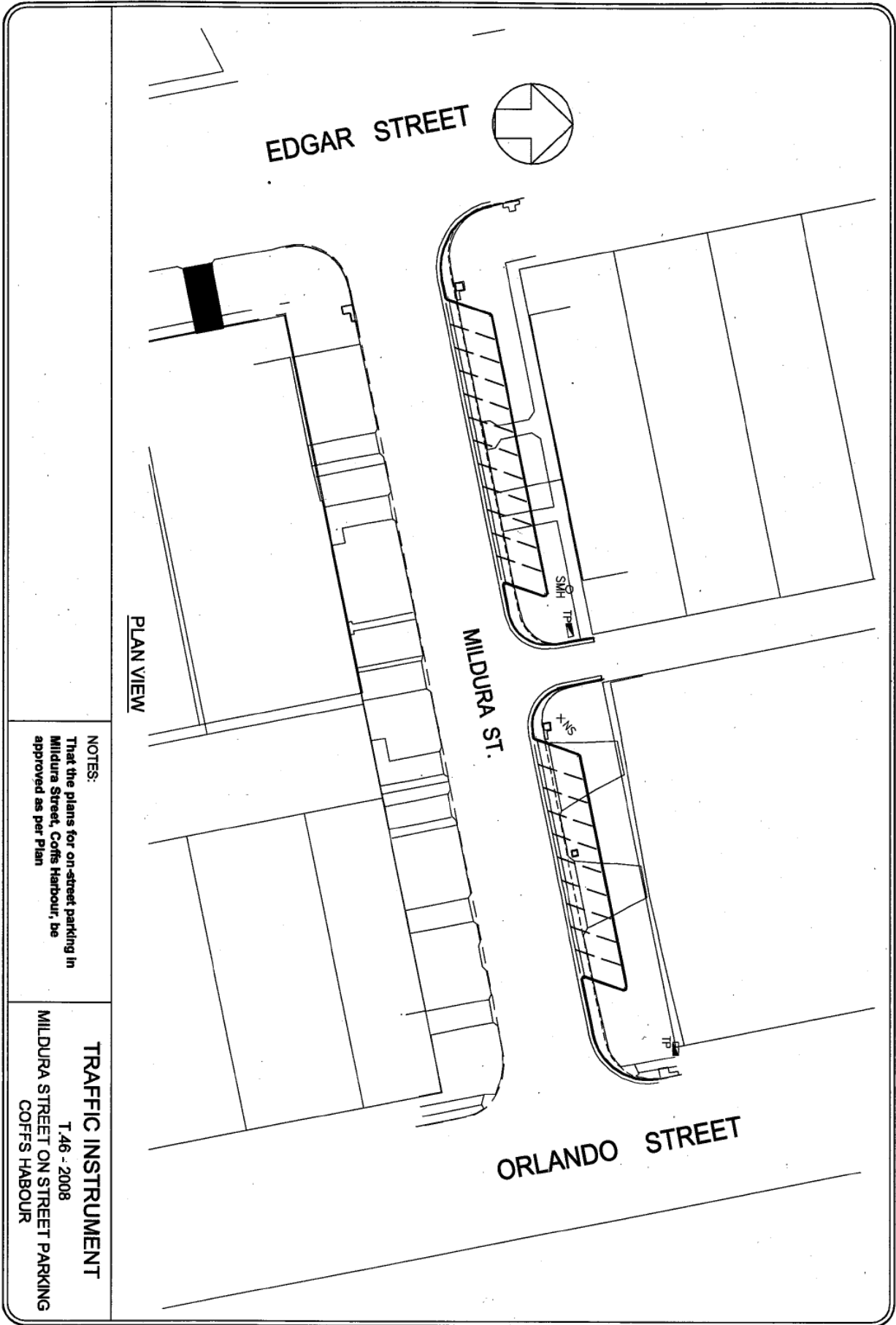

EDGAR STREET

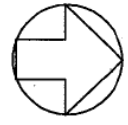

PLAN VIEW

MILDURA ST.

ORLANDO STREET

NOTES:
That the plans for on-street parking in Mildura Street, Coff's Harbour, be approved as per Plan

TRAFFIC INSTRUMENT
T.46 - 2008
MILDURA STREET ON STREET PARKING
COFFS HARBOUR

S32 NATIONAL SURF LIFE SAVING CHAMPIONSHIPS, BOAMBEE BEACH - PART 3A APPLICATION

Purpose:

To report on progress of discussions with Department of Planning and DECC on the approval process for proposed infrastructure works associated with staging of National Surf Life Saving Championships on Boambee Beach.

Description of Item:

Boambee Beach is a Crown Reserve currently managed under the Coastal Reserves Plan of Management. Coffs Harbour City Council is the Trust Manager of the Reserve.

The proposed infrastructure required for staging of National Surf Lifesaving Championships on the northern end of Boambee Beach includes; car parks, public amenities, services, beach access points, accommodation areas and link roads to Howard Street and Jordan Esplanade.

A particular development or development type may be declared a major project to be assessed under Part 3A of the Environmental Planning and Assessment Act 1979. The Minister for Planning's approval is required for these projects and they are ordinarily assessed by the Department of Planning.

Boambee Beach is within the Coastal Zone as defined in State Environmental Planning Policy (Major Projects) 2005. The proposed infrastructure works may therefore require Part 3A approval.

To initiate the Part 3A process for Boambee Beach, Council must request that the Minister form the opinion that the project is a project to which Part 3A of the Act applies.

The Part 3A application comprises a three-stage process.

Stage 1: Project Application and preparation of Environmental Assessment

Stage 2: Exhibition, consultation and review

Stage 3: Assessment and determination

The first stage consists of two discrete steps: -

1. Submission of Project Application with outline of proposal and request for determination on whether Part 3A applies.
2. Submission of Preliminary Project assessment and issue of Director- Generals Environmental Assessment requirements.

This report seeks approval for step one only.

Sustainability Assessment:

On submission of a Preliminary Project assessment and on issue of Director-General's Environmental Assessment requirements, an Environmental Assessment of the project will be prepared which will address all environment, social and economic Impacts of the project.

Management Plan Implications

Submission of Part 3A Project Application will have no impact on Council's Management Plan.

Consultation:

While preliminary consultation on the project has been undertaken with stakeholder groups the Part 3A process will include a public exhibition period (30 days) and consideration of submissions.

Statutory Requirements:

Council in its role as manager of the Coffs Coast State Park Reserve Trust will be undertaking the preparation of a Plan of Management for Boambee Beach Reserve (within the Coffs Coast State Park) to define the value, use, management practices and intent for the broad public purpose for which the land has been reserved.

Under the Local Environment Plan Boambee Beach is Open Space 6A Public Recreation Zone.

Open Space 6A Public Recreation Zone allows development, without Development Consent, for the purpose of: 'any activity authorised by a Plan of Management under the Local Government Act, 1993 or the Crown Lands Act, 1989'.

Owners consent from all landowners will be required for the application. This will require sign-off from the Department of Lands for the Major Project application and from ARTC for the road over the railway bridge.

Implementation Date / Priority:

Submission of Project Application to the Department of Planning will be carried out on adoption of the recommendation.

Recommendation:

That a Project Application with outline of the proposal for the National Surf Lifesaving Championships on Boambee Beach and request for determination on whether Part 3A applies to the project be made to the Minister for Planning.

S33 WATER EFFICIENCY STRATEGIC PLAN - ADOPTION OF REVIEWED PLAN

Purpose:

The objective of this report is to inform Council that no submissions were received from the Coffs Harbour community as a result of the public exhibition of the draft Water Efficiency Strategic Plan (WESP). Three submissions were received from the Clarence Valley Council community, but no changes to the draft WESP are required as a result of these submissions. It is recommended that Council adopt the WESP.

Description of Item:

At its meeting of 13 December, 2007, Council resolved to place the draft review of the Regional Water Efficiency Strategic Plan on public exhibition from December, 2007 to the end of February, 2008 for comment from the community. No submissions were received from the Coffs Harbour community during this time, however our Regional Water Supply Scheme (RWSS) partners, Clarence Valley Council, received three submissions from the Clarence Valley community (review of submissions attached). No issues were raised in these submissions which required any changes to be made to the WESP.

The WESP (a copy of the Plan is available for viewing in the Councillors room) is the major non-build component of the RWSS. WESP has now been in place and operating for approximately 10 years. It is a commitment to a more ecologically sustainable use and management of Council's water supply, and a framework for a range of key action plans, which address how Council and the community manage and use water.

Sustainability Assessment:

- **Environment**

The WESP is Council's blueprint for minimising water consumption into the future, with links to the Sewerage Strategy for water reclamation and re-use. It also aims to enhance river health through protecting environmental flows, or by investigation and implementation of alternate water sources. Effective implementation of the WESP reduces demand for water and therefore increases the useful life of the new Shannon Creek Storage Dam, currently under construction, and delays the need for further dam building.

- **Social**

This Plan has been developed, reviewed and updated from active community input. This latest period of public exhibition is an example of this. Community involvement helps to understand how our community presently uses water, what the community knows about ecologically sustainable water use, and what measures they will accept. The WESP also has a role to play in Council strategies to provide for healthy, liveable communities.

- **Economic**

Broader Economic Implications

WESP has been budgeted into Water Supply as an integral component of its operations for many years now. For example, part of this budget offers Coffs Harbour City Council town water customers incentives to become more water efficient.

S33 - Water Efficiency Strategic Plan - Adoption of Reviewed Plan (Cont'd)

Consultation:

A broad cross section of community representatives have been involved from the beginning, starting with the workshop to provide foundation material for the WESP, held in Grafton in November, 1997. Regular meetings with the Water Efficiency Team (WET) since that time have been invaluable opportunities for community input. The WESP review, held in Grafton in June 2006, was again an open community workshop. Sustainable Futures Australia have been contracted to help develop and review the WESP.

The latest groups to offer input into the WESP were those completing submissions as a result of the public exhibition period; South Grafton Residents Progress Association, Clarence Environment Centre and the Clarence Valley Conservation Coalition.

Related Policy and / or Precedents:

The current WESP has been in use by Coffs Harbour Water and North Coast Water since 1998.

The WESP assists Council to comply with the NSW Department of Water and Energy Best Practice Management of Water Supply and Sewerage Guidelines (2004) in that it forms an integral part of the Coffs Harbour Water Supply Demand Management Plan.

Statutory Requirements:

Licence requirements (Shannon Creek Dam License No 66010) call for a fully functional WESP. Part of the Dam License requires that the Implementation Plan "shall be prepared with a view to achieving the following objectives:"

- (iv) favourable community attitude towards resource conservation
- (v) community involvement in it's development
- (vi) acceptance of the WEIP by the community

Issues:

The WESP was established to cover a fifty-year time period to 2046. It has now been in place and operating for the first ten years of this period. It is a commitment to a more ecologically sustainable future in the way the Coffs Harbour community use and manage water in the region, and a framework for a range of key action plans to address these issues. To remain relevant to the Coffs Harbour community, the WESP needs to be regularly updated with stakeholder involvement.

Implementation Date / Priority:

It is proposed that the draft document be immediately adopted as the final WESP.

Recommendation:

That the draft Water Efficiency Strategic Plan be adopted by Council with a review to be undertaken in five years time.

Jason R Gordon
Director of City Services

Attachments:

Review of Submissions received during public exhibition of Water Efficiency Strategic Plan (14/12/07 to 29/2/08)

Submission received from South Grafton Residents Progress Association (Secretary Laurie Marchant author);

Issue	CVC Comment
Congratulations on the plan	Noted. Thanks for involvement and commitment
No need for regular meetings, unless necessary for policy changes. Consider the 5 year review essential.	Annual meetings will remain, but can provide this group with minutes. Agree with the 5 year review
Relevant reports sent to Council should be sent to WET members	Agreed
Broadly relevant water efficiency issues; Water pricing should not disadvantage lower socio economic groups, health standards or industry financial viability Need to monitor, report and publish the quality and release of re-use water and its environmental impacts.	Water pricing regulated by DWE. CVC agrees in principle Any release or re-use of recycled water is monitored by DECC. Refer to Water Cycle Manager.

Submission received from Clarence Environment Centre (Secretary John Edwards author)

Issue	CVC Comment
Because Shannon storage is 33% larger than Healthy Rivers Commissions recommendation (HRC 1999) and can increase by another 130%, the statement "water efficiency plays a vital role in reducing the need for a much larger storage" is hardly relevant.	Water Efficiency was a determining factor in Shannon storage sizing and an integral component in ensuring that Shannon provides a secure supply for more years than designed for.
Because Shannon storage will only be utilised when the Nymboida flows are below the 95th percentile, water efficiency will only be relevant when the storage had a capacity of six months supply or less.	Philosophy of WESP is to extend life of Shannon storage, and more importantly using water sustainably.
CEC has been involved with WET since inception and has had input into WESP, and commends the document and all involved in its compilation. WESP effectiveness will only be as good as its implementation	Noted. Thanks for involvement and commitment CVC is committed to ongoing implementation of WESP
CEC opposes any disbanding of WET, which should continue to meet to monitor compliance to the WESP.	Agreed. Water Efficiency Working Group will meet annually as per 29/11/07 meeting minutes.

Submission received from Clarence Valley Conservation Coalition (Secretary Leonie Blain author)

Issue	CVC Comment
CVCC has been actively involved in water and catchment related issues, was represented in and supports the WESP update.	Noted. Thanks for involvement and commitment
WESP effectiveness reliant on implementation. Commitment to and resourcing of WESP ongoing beyond Shannon storage being operational. Community input and consultation should be transparent and an important role of WESP. WET role should continue, inclusive of reporting on implementation of WESP, receiving community feedback, and 2012 review. (Similarly for the River Monitoring Committee).	Agreed. CVC is committed to ongoing implementation of WESP. Agreed. Water Efficiency Working Group will meet annually as per 29/11/07 meeting minutes.

CVC and CHCC should lobby state & federal govt.	WESP addresses alternative water sources
---	--

to develop alternative water sources (e.g. renewable powered desalination, greywater).	inclusive of a watching brief and taking advantage of opportunities as they arise
Water accounts should display comparisons of water usage over consecutive billing periods similar to current Country Energy accounts.	WEC will investigate.
Need to check all abbreviations are included in Abbreviation list	WEC has made changes.
Further progress in; Community education in water efficiency Raising community awareness in alternative water sources & reducing river extraction. Expand use of recycled water Promote water efficient gardens (public and household) Incentives for older dwellings for water efficiency hardware Decrease water losses in the reticulation system.	Agreed Work is identified in Strategic Action Plan of WESP.