



COFFS HARBOUR CITY COUNCIL

ORDINARY MEETING

(CITY SERVICES COMMITTEE)

COUNCIL CHAMBER

COUNCIL ADMINISTRATION BUILDING

COFF AND CASTLE STREETS, COFFS HARBOUR

18 NOVEMBER 2004

**Commencing at the conclusion of the
Planning, Environment & Development Committee**

Contents

ITEM	DESCRIPTION	PAGE
	CITY SERVICES DEPARTMENT REPORTS	1
S59	TRAFFIC COMMITTEE MEETING NO. 8/2004	1
S60	HOGBIN DRIVE - AVIATION DRIVE INTERSECTION	18
S61	WORKS BRANCH REPORT	20



COFFS HARBOUR CITY COUNCIL

ORDINARY MEETING

(CITY SERVICES COMMITTEE)

18 NOVEMBER 2004

Mayor and Councillors

CITY SERVICES DEPARTMENT REPORTS

S59 TRAFFIC COMMITTEE MEETING NO. 8/2004

Purpose:

To confirm minutes from the Traffic Committee meeting held on 4 November 2004.

Recommendation:

T.80 – First Avenue, Sawtell - Double Unbroken Lines (501520)

That double unbroken centre lines be installed in First Avenue, Sawtell, from Twentieth Avenue to a point 30m south of Fourth Avenue, as per Plan T.80.

T.81 – First Avenue, Sawtell - Pedestrian Refuges (501520 [927771])

That the amended design plan for pedestrian refuges and associated ramps in First Avenue, Sawtell, at the intersection of Twentieth Avenue, be approved, as per Plan T.81.

T.82 – Boronia Street, Sawtell - Traffic Calming (501140 [381987])

That installation of traffic calming devices in Boronia Street (East), Sawtell, be approved in principal as per Plan T.82, subject to the following:

- (a) Consultation be undertaken with the relevant stakeholders, including the bus companies.
- (b) Consultation with the affected residents, particularly in regard to increased noise.

cont'd

S59 Traffic Committee Meeting No. 8/2004 (cont'd)

T.83 – Lyons Road, Sawtell – Pedestrian Refuge (500170)

That the design plan for a proposed pedestrian refuge in Lyons Road, Sawtell, south of Chinaman's Creek, be approved, as per Plan T.83.

T.84 – Park Avenue, Coffs Harbour - Parking zones (505670)

That the existing Taxi Rank in Park Avenue, Coffs Harbour, be replaced with '15 minute' parking restriction, as per Plan T.84.

T.85 – Orlando Street, Coffs Harbour - Parking Zones (R.504030 / [999843])

That installation of '2 hour' parking restrictions in Orlando Street, Mildura Street and Collingwood Street, Coffs Harbour, be approved as per Plan T.85, following consultation of affected businesses.

T.86 – Cnr Harbour Drive/Gordon Street, Coffs Harbour - Parking Zones (Harbour Drive / [1010043])

That the 'nose in' disabled parking bay in Harbour Drive, Coffs Harbour, adjacent the ANZ Bank, be replaced with parallel parking, as per Plan T.86.

T.87 – Gaudrons Road, Sapphire - Linemarking (R.506500 [1001915])

That linemarking be installed at the intersection of Gaudrons Road and the Pacific Highway, Sapphire, as per Plan T.87.

T.88 – Hoys Road, Moonee Beach - B-Double Access (R.506810 [778778])

That Council approved the gazettal of Hoys Road, Moonee Beach, for B-Double access between the hours of 4.00pm-5.00pm Friday and 4.30pm-5.30pm Sunday.

T.89 – First Avenue, Sawtell - Temporary Road Closure (R.501520 / 1618 [1010377])

That :

- (a) the temporary road closure of First Avenue, Sawtell , between Boronia Street and Second Avenue, from 6.30am to 11.00am on Saturday, 1st January 2005, for the purpose of conducting the street parade associated with the Sawtell Super Fun Day, be advertised and providing no substantive objections are received, the closure be approved.
- (b) the organisers of the Fun Day liaise with affected traders and obtain traders approval.
- (c) the organisers be responsible for erection of traffic barriers and control of traffic using accredited traffic controllers.
- (d) the organisers be responsible for all costs associated with the temporary closure and clean up, including advertising.

T.90 – Harbour Drive, Coffs Harbour - Temporary Road Closure (Harbour Drive 1618)

That :

- (a) the temporary road closure of Harbour Drive, Coffs Harbour , between Pacific Highway and Gordon Street, from 7.00am to 2.00pm on Saturday, 4 December 2004, for the purpose of welcoming Santa to the City Centre, be advertised and providing no substantive objections are received, the closure be approved.
- (b) the organisers, Streets Ahead, liaise with affected traders and obtain traders approval.
- (c) the organisers be responsible for erection of traffic barriers and control of traffic using accredited traffic controllers.
- (d) the organisers be responsible for all costs associated with the temporary closure and clean up, including advertising.

T.91 – Jordan Esplanade, Coffs Harbour - Temporary Road Closure (506100 / 1618)

That :

- (a) the temporary road closure of Jordan Esplanade, Coffs Harbour, between Marina Drive and carpark entry to Jetty, from 6.00pm on Friday, 31 December 2004 to 6.00am on Saturday, 1 January 2005, for the purpose of holding New Years Eve celebrations, be advertised and providing no substantive objections are received, the closure be approved.
- (b) the organisers, March's Amusements, liaise with affected traders and obtain traders approval.
- (c) the organisers be responsible for erection of traffic barriers and control of traffic using accredited traffic controllers.
- (d) the organisers be responsible for all costs associated with the temporary closure and clean up, including advertising.

T.92 – Lyons Road, Sawtell - Intersection with North Bonville DCP (R.500170 / North Bonville DCP)

That plans for new intersections on Lyons Road for North Bonville DCP, be approved, as per Plan. T.92

Attachments:

**COFFS HARBOUR CITY COUNCIL
TRAFFIC COMMITTEE MINUTES 8/2004
4 NOVEMBER 2004 - 10.30AM**

Present: Councillor Bill Palmer, Coffs Harbour City Council
Snr Constable Wal Brooks, Coffs Harbour Police
Sgt Brian Hughes, Coffs Harbour Police
Graham Carthew, Roads and Traffic Authority
Peter West, Coffs Harbour Taxi Network
George Stulle, Coffs Harbour City Council
Peter Kitching, Coffs Harbour City Council
Anne Shearer, Coffs Harbour City Council

Minute Taker: Ann Graham

T.80 – First Avenue, Sawtell - Double Unbroken Lines (501520)

Consideration to a request for double unbroken lines in First Avenue, Sawtell, from Twentieth Avenue to a point 30m south of Fourth Avenue.

Recommended: that double unbroken centre lines be installed in First Avenue, Sawtell, from Twentieth Avenue to a point 30m south of Fourth Avenue, as per Plan T.80.

T.81 – First Avenue, Sawtell - Pedestrian Refuges (501520 [927771])

Consideration to an amended plan for pedestrian refuges in First Avenue, Sawtell, at the intersection of Twentieth Avenue.

Recommended: that the amended design plan for pedestrian refuges and associated ramps in First Avenue, Sawtell, at the intersection of Twentieth Avenue, be approved, as per Plan T.81.

T.82 – Boronia Street, Sawtell - Traffic Calming (501140 [381987])

Consideration to a design plan for installation of traffic calming measures in Boronia Street, Sawtell.

Recommended: that installation of traffic calming devices in Boronia Street (East), Sawtell, be approved in principal as per Plan T.82, subject to the following:

- (a) Consultation be undertaken with the relevant stakeholders, including the bus companies.
 - (b) Consultation with the affected residents, particularly in regard to increased noise.
-

T.83 – Lyons Road, Sawtell – Pedestrian Refuge (500170)

Consideration to a design plan for a proposed pedestrian refuge in Lyons Road, Sawtell, south of Chinaman's Creek.

Recommended: that the design plan for a proposed pedestrian refuge in Lyons Road, Sawtell, south of Chinaman's Creek, be approved, as per Plan T.83.

T.84 – Park Avenue, Coffs Harbour - Parking zones (505670)

Consideration to the installation of '15 minute' parking zone in Park Avenue, Coffs Harbour, to replace the taxi rank west of Woolworths.

Recommended: that the existing Taxi Rank in Park Avenue, Coffs Harbour, be replaced with '15 minute' parking restriction, as per Plan T.84.

T.85 – Orlando Street, Coffs Harbour - Parking Zones (R.504030 / [999843])

Consideration to a request for '1/2 hour' restricted parking in Orlando Street (western side), Coffs Harbour, to enable customers to access businesses after Gem Apartments are open.

Recommended: that installation of '2 hour' parking restrictions in Orlando Street, Mildura Street and Collingwood Street, Coffs Harbour, be approved as per Plan T.85, following consultation of affected businesses.

T.86 – Cnr Harbour Drive/Gordon Street, Coffs Harbour - Parking Zones (Harbour Drive / [1010043])

Consideration to restricting parking in Harbour Drive, Coffs Harbour, adjacent the ANZ Bank, due to the dangerous situation of cars reversing from car spaces colliding with cars turning left from Gordon Street.

Recommended: that the 'nose in' disabled parking bay in Harbour Drive, Coffs Harbour, adjacent the ANZ Bank, be replaced with parallel parking, as per Plan T.86.

T.87 – Gaudrons Road, Sapphire - Linemarking (R.506500 [1001915])

Consideration to a request for linemarking on Gaudrons Road, Sapphire, as there are a number of blind bends creating a dangerous situation.

Recommended: that linemarking be installed at the intersection of Gaudrons Road and the Pacific Highway, Sapphire, as per Plan T.87.

T.88 – Hoys Road, Moonee Beach - B-Double Access (R.506810 [778778])

Consideration to approval of permanent status of B-Double access for M Harrington to use Hoys Road, Moonee Beach, from Pacific Highway to No. 104 Hoys Road.

Recommended: that Council approved the gazettal of Hoys Road, Moonee Beach, for B-Double access between the hours of 4.00pm-5.00pm Friday and 4.30pm-5.30pm Sunday.

T.89 – First Avenue, Sawtell - Temporary Road Closure (R.501520 / 1618 [1010377])

Consideration to the temporary road closure of First Avenue, Sawtell, between Second Avenue and Boronia Street, on Saturday, 1st January 2005, between the hours of 6.30am and 11.00am for the purpose of holding the Sawtell Super Fun Day.

Recommended: that :

- (a) **the temporary road closure of First Avenue, Sawtell , between Boronia Street and Second Avenue, from 6.30am to 11.00am on Saturday, 1st January 2005, for the purpose of conducting the street parade associated with the Sawtell Super Fun Day, be advertised and providing no substantive objections are received, the closure be approved.**
-

- (b) the organisers of the Fun Day liaise with affected traders and obtain traders approval.
 - (c) the organisers be responsible for erection of traffic barriers and control of traffic using accredited traffic controllers.
 - (d) the organisers be responsible for all costs associated with the temporary closure and clean up, including advertising.
-

T.90 – Harbour Drive, Coffs Harbour - Temporary Road Closure (Harbour Drive 1618)

Consideration to the temporary road closure of Harbour Drive, Coffs Harbour, between Pacific Highway and Gordon Street, on Saturday, 4 December 2004 between the hours of 7.00am and 2.00pm for the purpose of welcoming Santa to the City Centre.

Recommended: that :

- (a) the temporary road closure of Harbour Drive, Coffs Harbour , between Pacific Highway and Gordon Street, from 7.00am to 2.00pm on Saturday, 4 December 2004, for the purpose of welcoming Santa to the City Centre, be advertised and providing no substantive objections are received, the closure be approved.
 - (b) the organisers, Streets Ahead, liaise with affected traders and obtain traders approval.
 - (c) the organisers be responsible for erection of traffic barriers and control of traffic using accredited traffic controllers.
 - (d) the organisers be responsible for all costs associated with the temporary closure and clean up, including advertising.
-

T.91 – Jordan Esplanade, Coffs Harbour - Temporary Road Closure (506100 / 1618)

Consideration to the temporary road closure of Jordan Esplanade, Coffs Harbour, between Marina Drive and carpark entry to Jetty between the hours of 6.00pm on Friday, 31 January 2004 and 6.00am on Saturday, 1 January 2005, for the purpose of New Years Eve celebrations.

Recommended: that :

- (a) the temporary road closure of Jordan Esplanade, Coffs Harbour, between Marina Drive and carpark entry to Jetty, from 6.00pm on Friday, 31 December 2004 to 6.00am on Saturday, 1 January 2005, for the purpose of holding New Years Eve celebrations, be advertised and providing no substantive objections are received, the closure be approved.
 - (b) the organisers, March's Amusements, liaise with affected traders and obtain traders approval.
 - (c) the organisers be responsible for erection of traffic barriers and control of traffic using accredited traffic controllers.
 - (d) the organisers be responsible for all costs associated with the temporary closure and clean up, including advertising.
-

T.92 – Lyons Road, Sawtell - Intersection with North Bonville DCP (R.500170 / North Bonville DCP)

Consideration to design plans for intersection on Lyons Road in accordance with North Bonville DCP.

Recommended: that plans for new intersections on Lyons Road for North Bonville DCP, be approved, as per Plan. T.92

The meeting closed at 12.55pm.

The next meeting for Traffic Committee will be Thursday 2 December 2004.

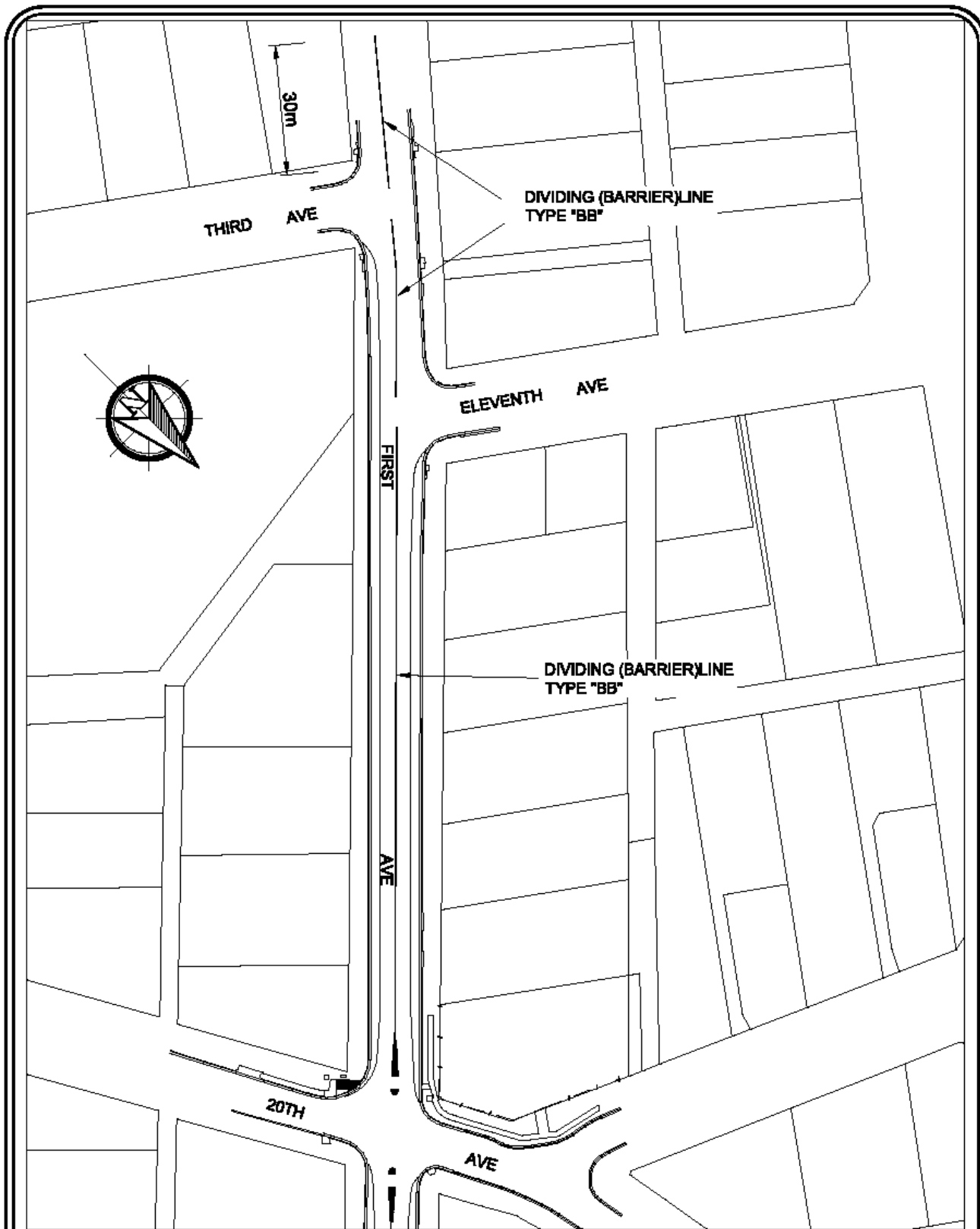

PLAN VIEW

NOTES:
 DOUBLE UNBROKEN CENTRE LINES BE
 INSTALLED IN FIRST AVENUE, SAWTELL, FROM
 TWENTIETH AVENUE TO A POINT 30M SOUTH
 OF THIRD AVENUE

TRAFFIC INSTRUMENT

**T.80-2004
 FIRST AVE
 SAWTELL**

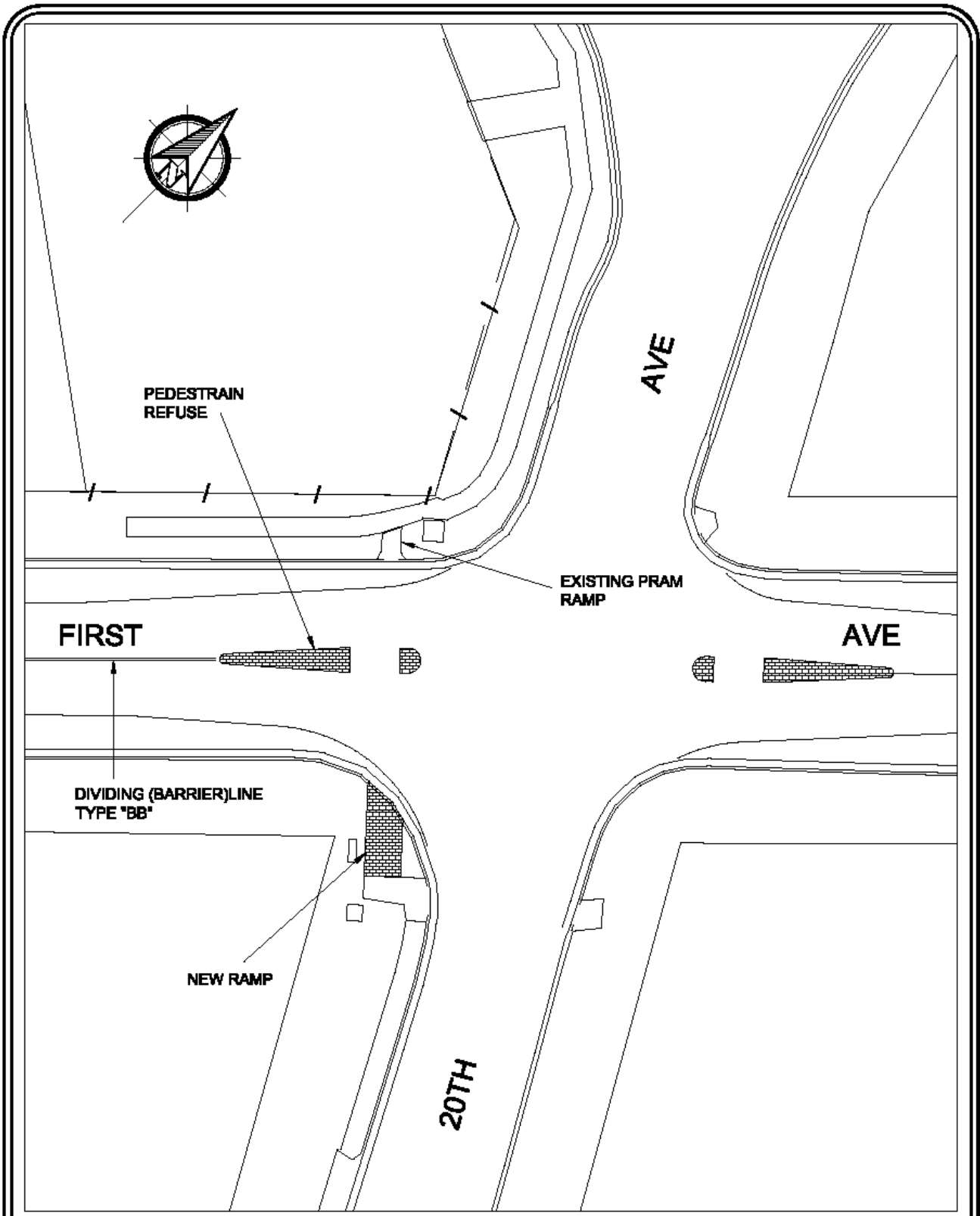

PLAN VIEW

NOTES:
 CONCEPT DESIGN PLAN FOR PEDESTRIAN
 REFUGES AND ASSOCIATED RAMPS IN FIRST
 AVENUE, SAWTELL, AT THE INTERSECTION OF
 TWENTIETH AVENUE

TRAFFIC INSTRUMENT

T.81-2004
 FIRST AVE
 SAWTELL

UC:\projects\812004\812004.dwg

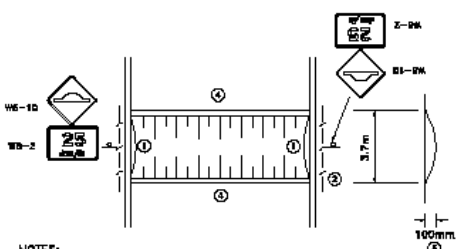
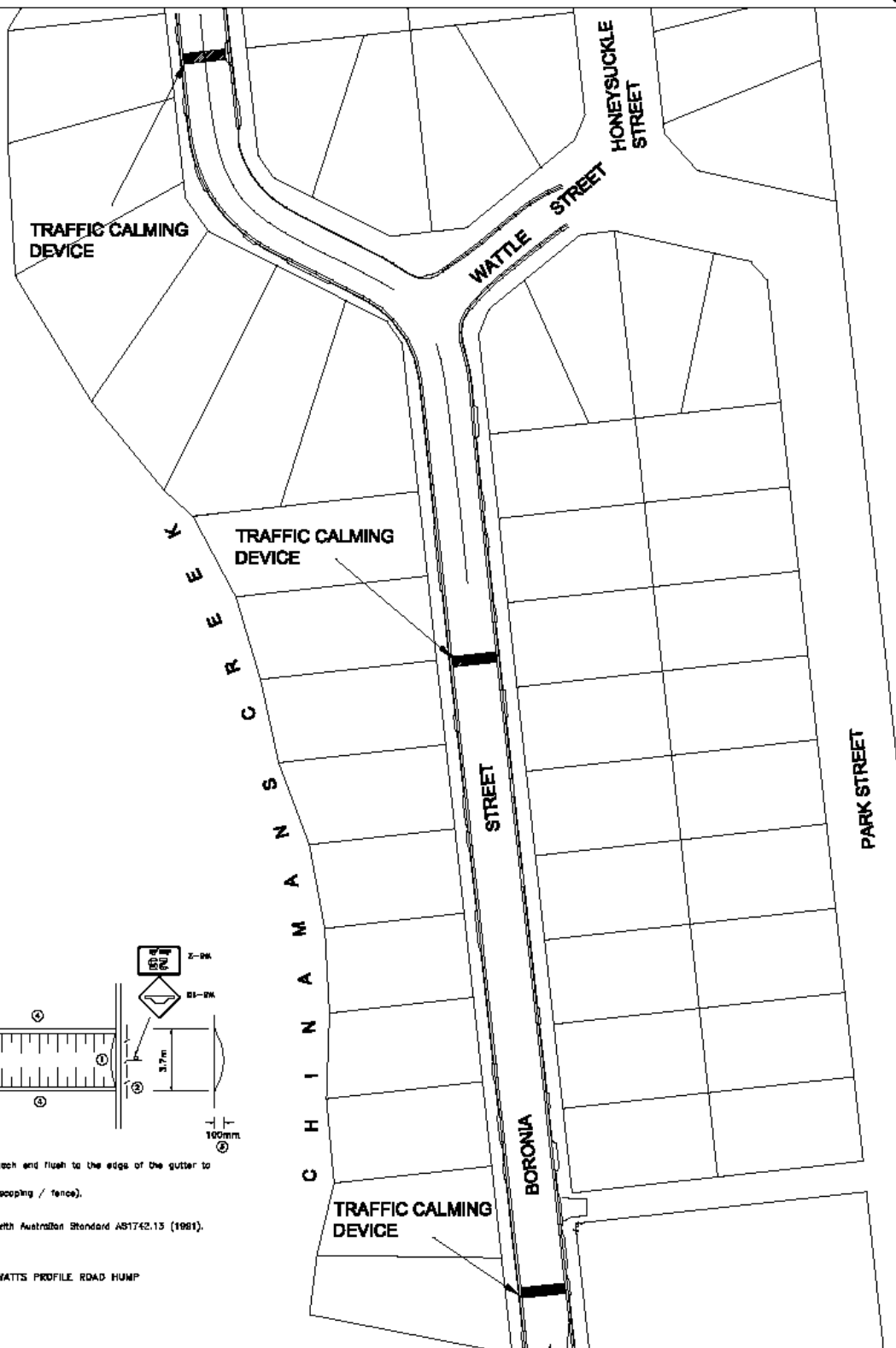

- NOTES:
- ① Taper the last 600mm at each end flush to the edge of the gutter to provide for drainage.
 - ② Pedestrian barrier (eg. landscaping / fence).
 - ③ Max. 75mm on bus routes.
 - ④ Mark hump in accordance with Australian Standard AS1742.13 (1991).

WATTS PROFILE ROAD HUMPS

PLAN VIEW

NOTES:
 CONCEPT INSTALLATION OF TRAFFIC CALMING DEVICES IN BORONIA STREET (EAST), SAWTELL

TRAFFIC INSTRUMENT

T.82-2004
 BORONIA STREET
 SAWTELL

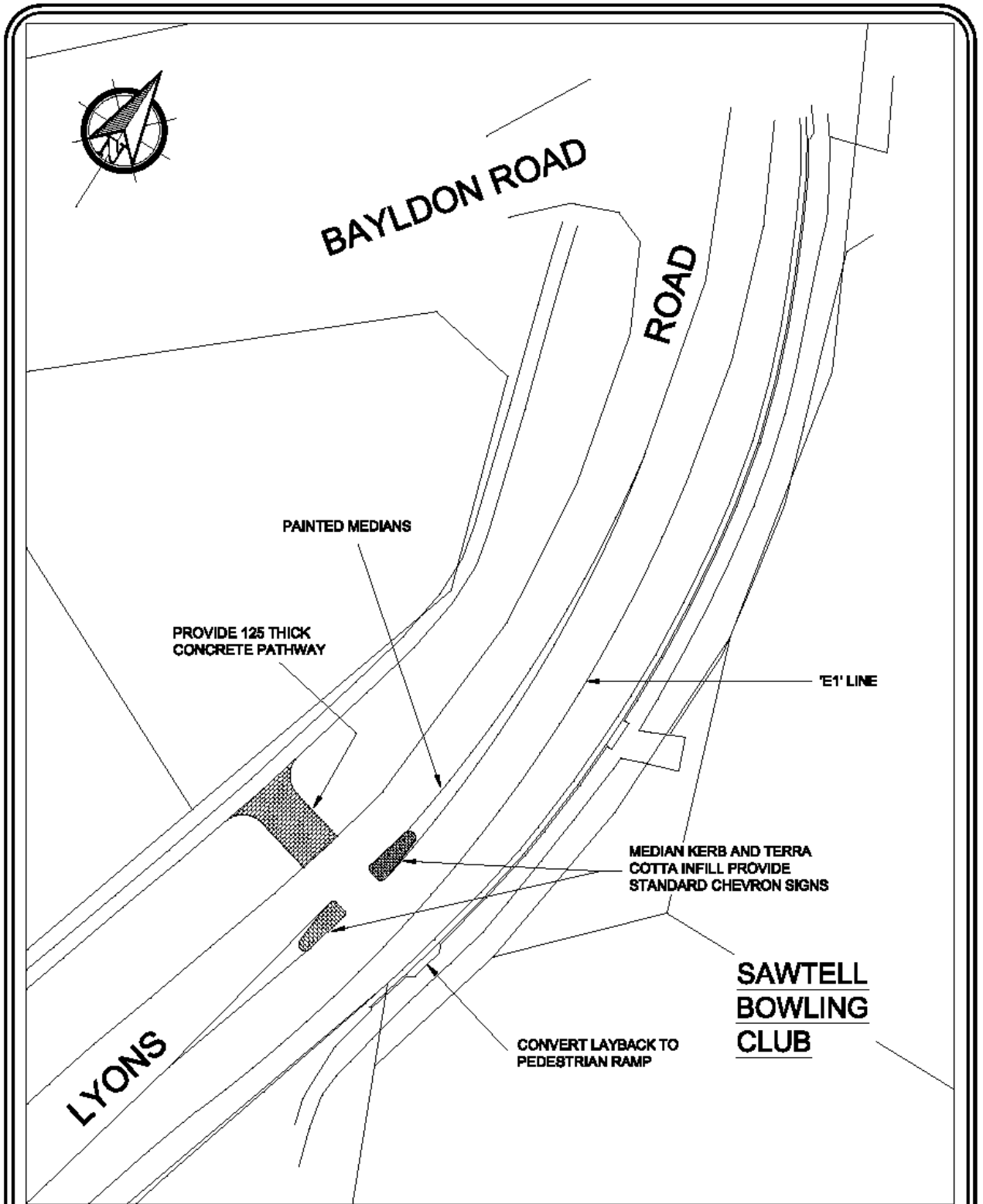

PLAN VIEW

NOTES:
 CONCEPT DESIGN PLAN FOR A PROPOSED
 PEDESTRIAN REFUGE IN LYONS ROAD,
 SAWTELL, SOUTH OF CHINAMAN'S CREEK

TRAFFIC INSTRUMENT

**T.83-2004
 LYONS ROAD
 SAWTELL**

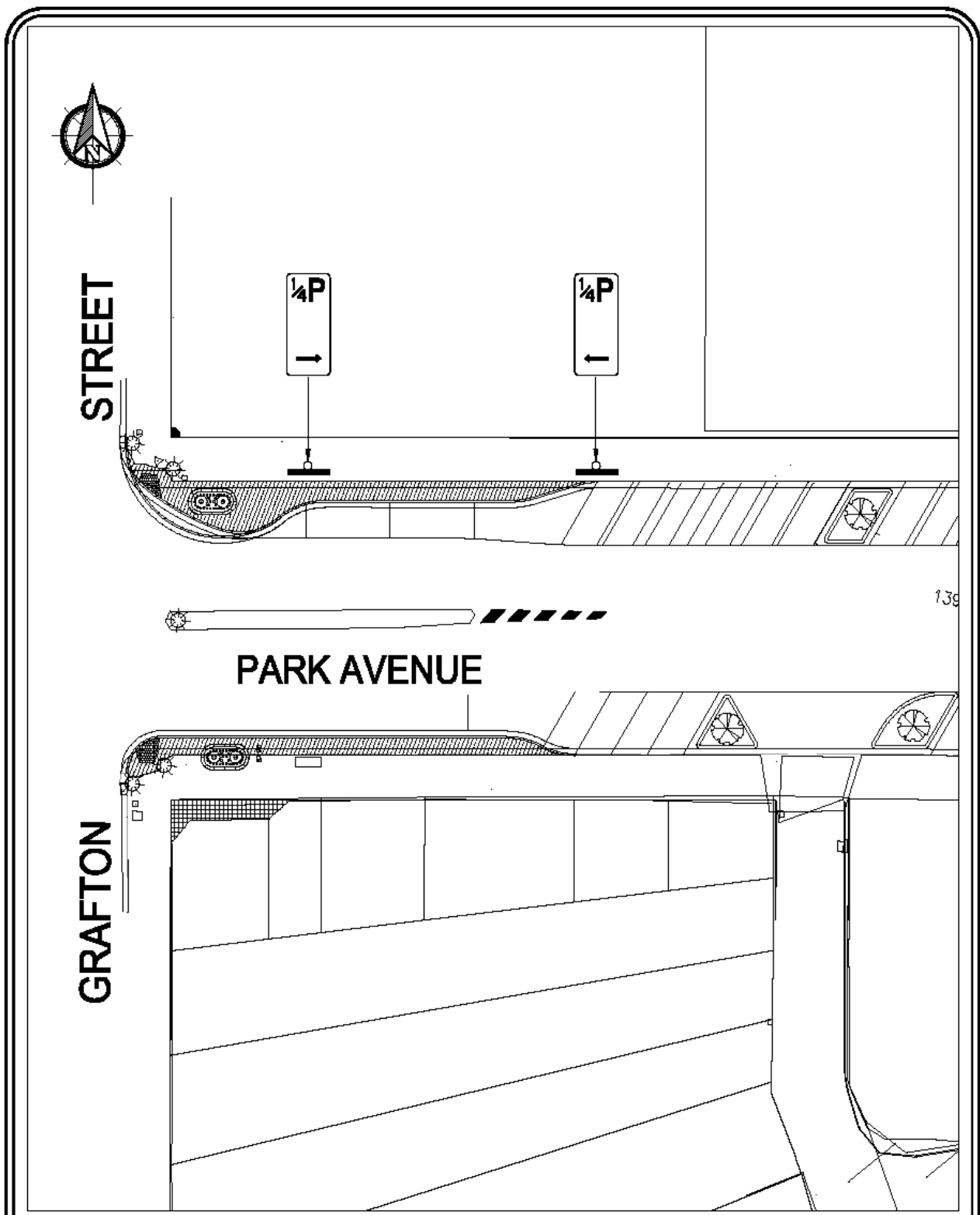

PLAN VIEW

EXISTING TAXI RANK IN PARK AVENUE, COFFS HARBOUR, BE REPLACED WITH '15 MINUTE' PARKING RESTRICTION

TRAFFIC INSTRUMENT
T.84-2004
PARK AVE
COFFS HARBOUR

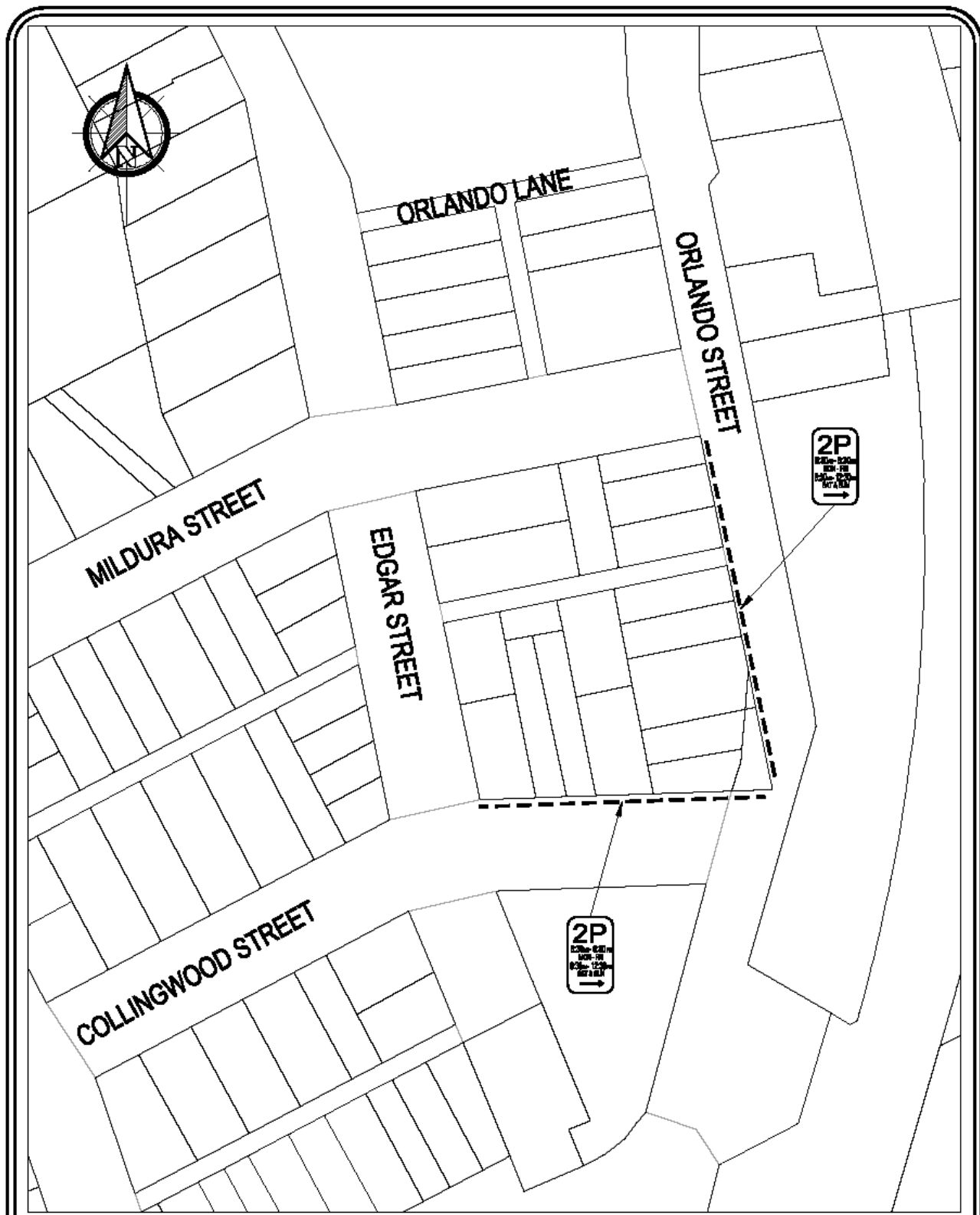

PLAN VIEW

NOTES:
 THAT INSTALLATION OF 2 HOUR PARKING
 RESTRICTIONS IN ORLANDO STREET, MILDURA
 STREET AND COLLINGWOOD STREET, COFFS
 HARBOUR

TRAFFIC INSTRUMENT
 T.85-2004
 ORLANDO ST
 COFFS HARBOUR

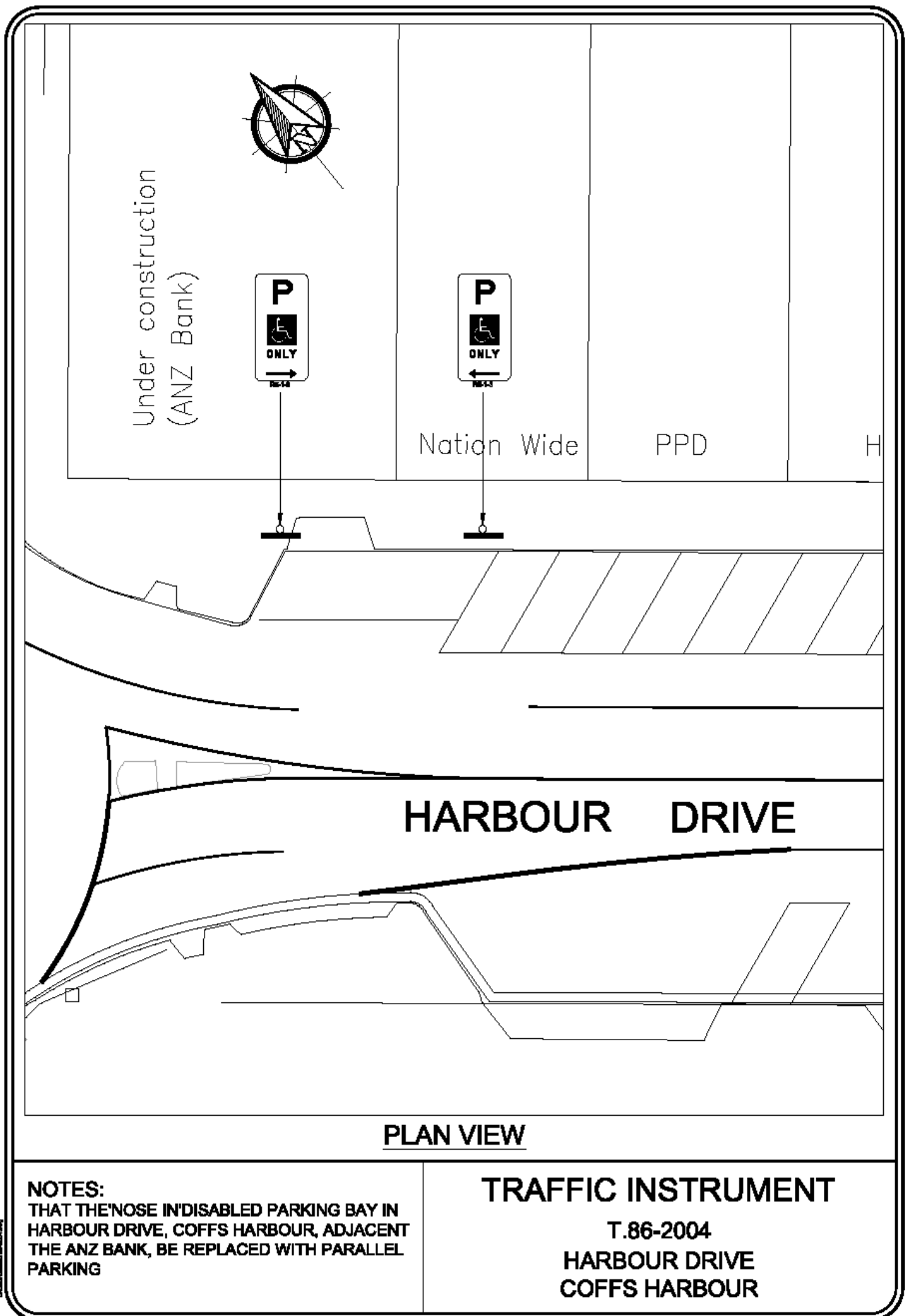

NOTES:
 THAT THE 'NOSE IN' DISABLED PARKING BAY IN
 HARBOUR DRIVE, COFFS HARBOUR, ADJACENT
 THE ANZ BANK, BE REPLACED WITH PARALLEL
 PARKING

TRAFFIC INSTRUMENT

T.86-2004
 HARBOUR DRIVE
 COFFS HARBOUR

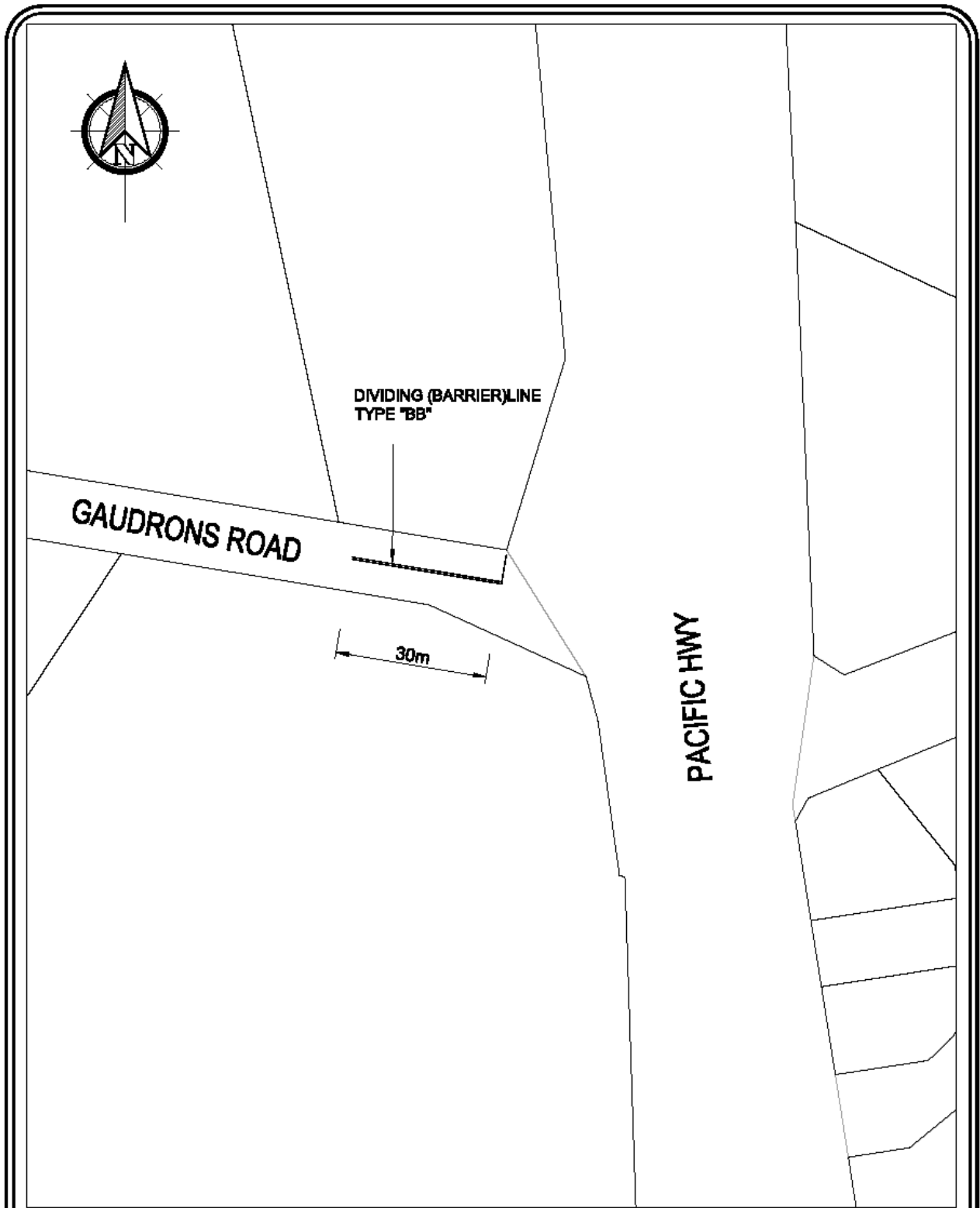

PLAN VIEW

NOTES:
 THAT LINEMARKING BE INSTALLED AT THE
 INTERSECTION OF GAUDRONS ROAD AND THE
 PACIFIC HIGHWAY, SAPPHIRE

TRAFFIC INSTRUMENT

**T.87-2004
 GAUDRONS ROAD
 SAPPHIRE**

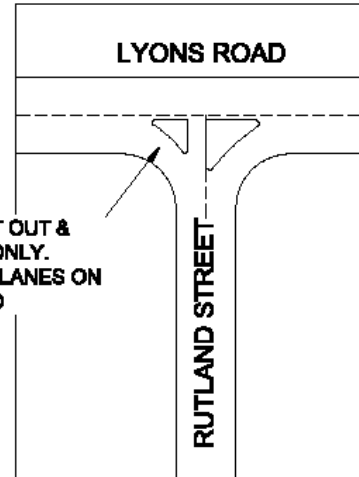
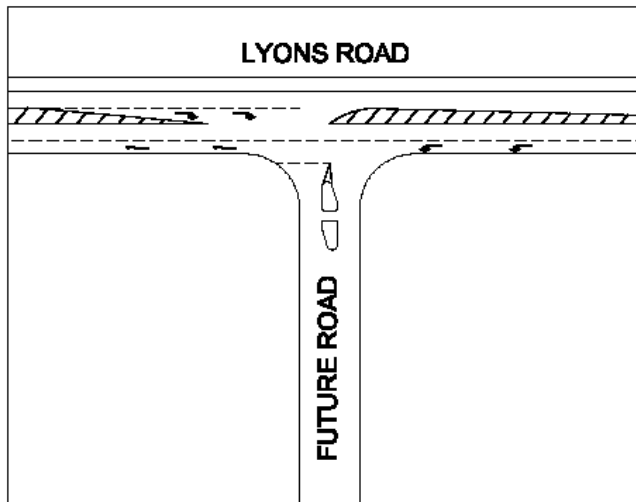

LEFT IN/LEFT OUT &
RIGHT OUT ONLY.
NEW ENTRY LANES ON
LYONS ROAD

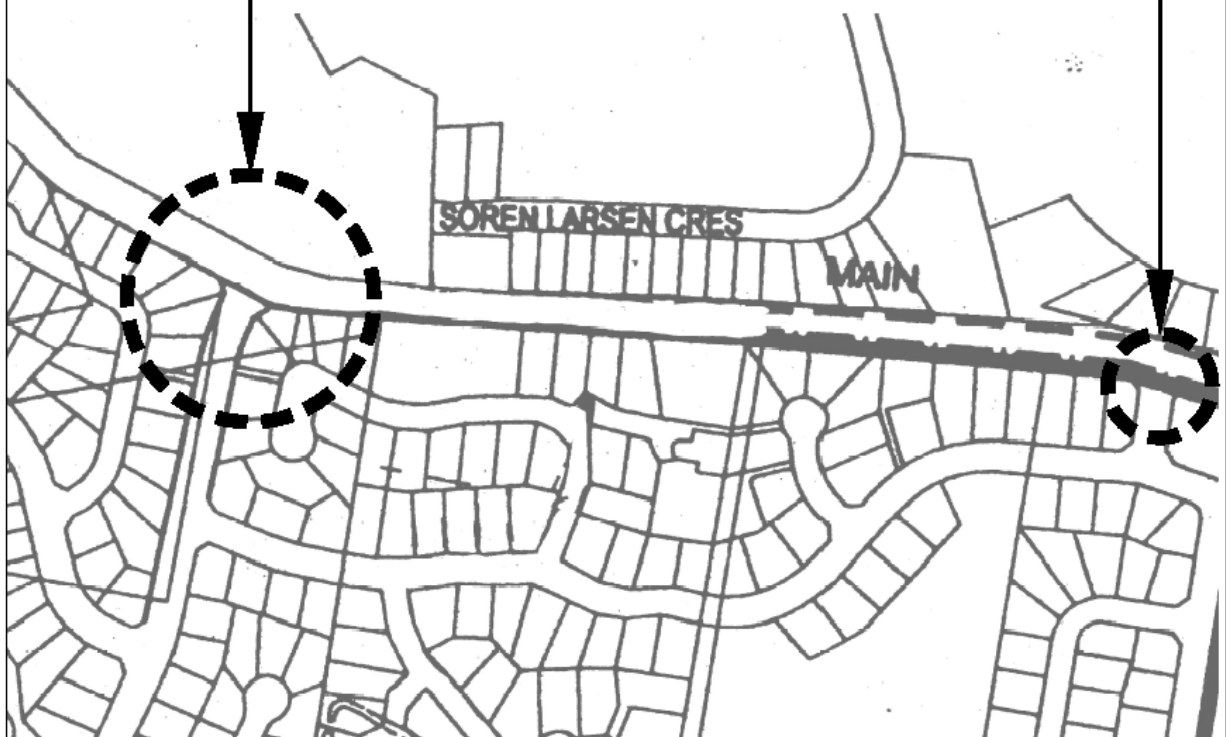

PLAN VIEW

NOTES:
PLANS FOR NEW INTERSECTIONS ON LYONS
ROAD FOR NORTH BONVILLE DCP, BE
APPROVED

TRAFFIC INSTRUMENT
T92.2004
LYONS ROAD
INTERECTION WITH NORTH BONVILLE DCP

S60 HOGBIN DRIVE - AVIATION DRIVE INTERSECTION

Purpose:

To report on options available for improvements to peak traffic flows at the Hogbin Drive/Aviation Drive intersection.

Description of Item:

Council at its meeting of 16 September 2004 resolved that:

1. *That design plans for a right turn acceleration lane on Hogbin Drive at the Airport Road be prepared in accordance with AUSTRROADS Standards for a 100km/h speed environment for review and costing.*
2. *That a further report be brought back to Council on the possibility of reducing the speed on Hogbin Drive adjacent to the airport turnoff as soon as possible and within a minimum of six weeks.*

The Hogbin Drive/Aviation Drive intersection was reconstructed in 2001 as part of the Regional Road Repair Program. The intersection is currently configured with short deceleration lanes for the right turn movement out of Aviation Drive and left turn movements into and out of Aviation Drive.

The intersection operates at a good level of service during non-peak flows however when arrival or departures of a commercial flight coincides with peak traffic flows on Hogbin Drive, increased delays are experienced for vehicles exiting Aviation Drive for a period of 20 to 30 minutes.

Intersection capacity could be improved if the current short acceleration/deceleration lanes were extended to comply with an 80-100km/h design speed. Concept design has been completed for this work and construction costs estimated to be in the order of \$350,000.

Sustainability Assessment:

- **Environment**

Traffic counts have been undertaken at the intersection and show that turning volumes are relatively low. The environmental benefit in terms of traffic efficiency in carrying out improvements to the intersection would be therefore minor.

The intersection improvement works could be carried out within the existing road reserve and would have negligible environmental impact.

- **Social**

Traffic analysis shows that the intersection operates effectively 85% of the time. Delays experienced during peak times while not significant, could be seen as an undesirable introduction for new visitors to the city.

cont'd

S60 Hogbin Drive - Aviation Drive Intersection (cont'd)

- **Economic**

The Hogbin Drive/Aviation Drive intersection does not have a significant crash history and as previously stated, is only subject to traffic delays for short periods of time. Cost benefit of carrying out major works would therefore be low.

No funds are identified in Council's Management Plan for any improvement works at this intersection.

Consultation:

No further consultation has been undertaken other than inter-departmental.

Issues:

Traffic analysis has shown that currently the 3.30pm to 4.30pm traffic peak provides worst conditions for vehicles existing Aviation Drive on to Hogbin Drive. Vehicles can experience delays in the order of 60-90 seconds, however this would only occur for a 15-20 minute period within the peak hours.

Overall the intersection operates at a level of service "B" which is good.

Reduction in speed limit has been investigated. Signposting the speed zone to say "60 km/h" during peak traffic times only is not possible under current NSW traffic legislation.

The speed zone could be varied using electronic variable speed signs, however this type of facility is not generally used other than on major freeways.

Reduction of the speed limit on Hogbin Drive to 80 km/h from Howard Street to Stadium Drive could be investigated as an option.

While major upgrade of the intersection does not currently appear to be warranted, as traffic volumes increased, reconstruction of the intersection will be required. Major reconstruction works on Hogbin Drive have been funded through the Regional Roads Repair Program. Whilst the program is fixed for the next three years, consideration should be given to inclusion of the intersection upgrade in future Repair Programs.

Recommendation:

That reconstruction of the Hogbin Drive/Aviation Drive intersection be listed for consideration in future Regional Road Repairs Programs at the time of the next review.

S61 WORKS BRANCH REPORT

Purpose:

To advise Council of the progress of construction and maintenance programs undertaken by Works Branch up to 31 October, 2004 and to provide an update on the emergency response to the Declared Natural Disaster of 20 October 2004.

Description of Item:

1. Completed Works

- Pavement Rehabilitation Beach Street, Nightingale to Boundary Street, Woolgoolga (asphalt outstanding)
- Footpath Construction Joyce Street, Tyalla Primary School to Greenlea Crescent, 220m

2. Works in Progress and Commencing in November, 2004

- Installation of leachate drainage system at Englands Road Waste Facility
- Footpath Construction, Phillip Street, Park Beach Road to Prince St, 255m
- Watermain Construction, Martin Street, Coramba
- Dust sealing, Timmsvale Road, Lowanna
- Drainage works, Ironbark Avenue, Sandy Beach.
Pipe relining 25 Watsonia Avenue, Coffs Harbour
Pipe relining 82-86 Gundagai Street, Coffs Harbour
- Pavement Rehabilitation, Gaudrons Road, Sapphire.
- Velodrome construction, Minorie Drive, Toormina

A financial attachment detailing expenditure verse budget for the 2004/2005 financial year is included for Councils information.

3. Operations and Maintenance

Operation and maintenance budgets are being monitored and are within the 2004/05 allocations.

4. Declared Natural Disaster.

Routine maintenance programs have been disrupted due to the damage caused by the Declared Natural Disaster on 20th October, 2004. Generally the damage was caused by the high winds rather than rain which could have resulted in flooding. A summary of the damage and preliminary estimates of the emergency and restoration costs are shown below.

The role of the State Emergency Service in emergency situations is to secure and make safe damaged property and provide relief and comfort to residents who have been affected.

cont'd

S61 Works Branch Report (cont'd)

Council staff are then responsible to undertake clean up in the removal of fallen trees, storm debris and repair the storm damage. In this role Council has employed upward of 80 outdoor staff, many contract trucks and several chippers over the past three weeks. During this time many hundreds of fallen trees have been removed from the road and park reserves, the historical jetty has been made safe, playgrounds and beach accesses restored. Also crews have been continually carrying out the community clean-up and assisting residents where possible.

During the storm Works and Parks & Recreation staff were primarily involved with responding to calls related to fallen trees over roads, on cars and houses. The storm damage was widespread, however the Ulong, Lowanna areas only suffered minor problems compared to the coastal strip.

As a result of the resources needed to undertake emergency works and restoration of the damaged incurred some capital works projects will be deferred. These are as follows;

1. Woolgoolga Town Centre Upgrade between Nightingale and Boundary Streets, now due to commence late January 2005.
2. Replacement of Woolgoolga Creek Road bridge, now due to commence late November, 2004.
3. Dust sealing is a month behind schedule, however should be completed prior to Christmas.

Damage Summary

Asset Damaged	Location	Comment
Public and Council Buildings	Council's Environmental Laboratory	Tree fell onto roof of building. Water damage sustained to building and lab equipment. (Building and contents insured)
	International Stadium	Offices and canteen area sustained storm and water damage. (Building and contents insured)
Historical Jetty	Coffs Harbour	Support piles for the lower landing and steps washed away during storm. (Subject to an insurance claim).
Boat Ramps	Coffs Harbour, and Arrawarra	Coffs Harbour boat ramp filled with sand due to the swell, Arrawarra boat ramp pavement damaged.
Council and State Reserves	Various	Trees blown over, shade sail structures over play equipment torn, beach accesses and fences damaged.
Council Road Reserves	Various	Trees and storm litter over roads, table drains blocked, guard rail damaged, gravel washouts and scours on unsealed roads.
Stormwater Drains	Various Locations	Debris removal from blocked stormwater drains.

cont'd

S61 Works Branch Report (cont'd)

Estimate of Costs

	Emergency	Restoration
Public Buildings		\$4,000
Drainage		\$25,000
Stormwater		
Retaining Walls		
Debris Removal - Council responsibility	\$124,892	\$683,560
- Private Property (70% estimated cost)		\$82,251
Water & Sewerage Supply	\$24,859	
Rock Protection		
Recreation Facilities		\$43,070
Damaged Fencing		\$5,500
Sub Total	\$149,751	\$843,381
Less Council Contribution		(\$25,000)
Total Claimable	\$149,751	\$818,381

The amount shown is subject to a claim being lodged with the Department of Commerce under the Natural Disaster Relief Program.

The Natural Disaster Relief Program dictates that Council will fund 25% of the first \$100,000 clean-up cost, whilst the Program will then fund the remainder. The conditions of the relief funding are that any community clean-up expenditure will be proportioned in a 70/30 split between Natural Disaster Relief Program and Council.

It is anticipated that the final cost to Council of the emergency response to the natural disaster may be in the order of \$60,000. These costs will be partially offset by the value of landscape material derived from the community clean-up. Final costings will not be known for another 3-4 weeks when works are completed.

A detailed report will be provided at a later date giving a full description of the nature and extent of the emergency, the costs and recommendations regarding actions, and the possible purchase of equipment against future emergencies.

Recommendation:

That:

- 1. Council notes the progress report on construction and maintenance works undertaken by Works Branch up to 1st November, 2004.**
- 2. Council notes that individual program expenditures are being monitored to ensure that the total program costs for 2004/2005 will be contained within the approved budget.**

Stephen Sawtell
Director of City Services

Attachments:**Works Branch-Construction Projects Budget/Expenditure
2004/2005 Program****AS AT DATE: 31-Oct-04**

Description	Revised Budget	Actual Expenditure	% Project Complete	% Costs Expended
Local Roads				
Sealed Roads Reseals	\$606,800	\$180,182	29%	30%
Sealed Roads Reseals - Asphalt	\$57,000	\$0	0%	0%
Sealed Roads Rehabilitation	\$1,247,004	\$399,381	31%	32%
Dust Sealing	\$155,000	\$287	0%	0%
Unsealed Roads Gravel Resheeting	\$140,900	\$28,577	22%	20%
Moonee Beach Rd Reconstruction	\$736,400	\$0	0%	0%
Diamond Head Dr Reconstruction	\$625,000	\$0	0%	0%
Bray St Upgrade	\$400,000	\$0	0%	0%
Total:	\$3,968,104	\$608,427		
Federal Roads to Recover				
Residential Street Rehabilitation	\$264,662	\$43,707	16%	17%
Gravel Resheeting	\$114,751	\$75,958	65%	66%
Bitumen Sealing	\$228,828	\$48,869	22%	21%
Total:	\$608,241	\$168,534		
Regional Roads				
3 X 3 Program	\$150,151	\$6,259	4%	4%
Total:	\$150,151	\$6,259		
Drainage				
Drainage Impts / Nuisance Flooding	\$259,265	\$76,625	30%	30%
Total:	\$259,265	\$76,625		
Bridges				
Major Repairs	\$204,746	\$4,340	1%	2%
Mt Brown Rail Bridge Approaches	\$35,580	\$0	0%	0%
Cathodic Protection	\$100,000	\$0	0%	0%
Total:	\$340,326	\$4,340		
Footpaths / Cycleways				
Footpath Construction	\$318,540	\$75,033	25%	24%
PAMPS Footpath Works	\$98,987	\$123	0%	0%
Cycleway Projects	\$244,345	\$94,181	37%	39%
Total:	\$661,872	\$169,337		
Water Mains				
Mains Renewals	\$238,000	\$133,687	54%	56%
Mains Extensions	\$50,000	\$0	0%	0%
Total:	\$288,000	\$133,687		